

playmobil®

Princess Magic★



71359



Hoch oben in den Wolken, schwebend über den endlosen Weiten des Magischen Reichs, liegt das himmlische Regenbogenschloss. Ein Ort der Glückseligkeit, der alle Wesen in seinen Bann zieht. Auch die Regenbogenprinzessinnen und Schwestern Talissia und Neela sind hier zu Hause und helfen, wo sie nur können.

High above the clouds, hovering over the endless expanses of the Magical Realm, lies the Heavenly Rainbow Castle. A place of bliss that casts a spell over all beings. The rainbow princesses and sisters Talissia and Neela are also at home here and help where they can.

La tourelle enchantée se trouve dans un royaume magique, au-dessus des nuages. Dans ce lieu magique, tous les habitants sont heureux. Les princesses arc-en-ciel et les sœurs Talissia et Neela y vivent et n'hésitent pas à proposer leur aide.

En lo alto de las nubes, flotando sobre las extensiones del Reino Mágico, se encuentra el Castillo Arcoíris en las Nubes. Un lugar que hechiza a todos los seres. Las princesas y hermanas del arcoíris, Talissia y Neela, también viven aquí y ayudan en lo que pueden.



HINWEIS
Note notice
Atención



Aufbauen leicht gemacht mit nummerierten Tüten. Viel Spaß mit deinem neuen PLAYMOBIL-Spielzeug!

Set-up made easy with numbered bags. Have fun with your new PLAYMOBIL toy!

Simplicité de montage avec les sachets numérotés. Amuse-toi avec tes nouveaux PLAYMOBIL!

El montaje es más fácil con las bolsas numeradas. ¡Diviértete con tu nuevo juguete de PLAYMOBIL!



WARNING:
CHOKING HAZARD

Contains a small ball and small parts.
Not for children under 3 years.

"Ne concerne que les USA"

Wichtige Unterlagen, bitte sorgfältig aufbewahren!
Important: Please keep these instructions for future reference!
Documents importants, à conserver soigneusement!
¡Por favor, guarde estas instrucciones para el futuro!
Belangrijke documenten, bewaar deze zorgvuldig!

Abbildungen können vom Original abweichen.
Product may differ from image shown.
Les illustrations peuvent différer de l'original.
Las ilustraciones pueden diferir del original.
Afbeeldingen kunnen verschillen van het werkelijke artikel.



+

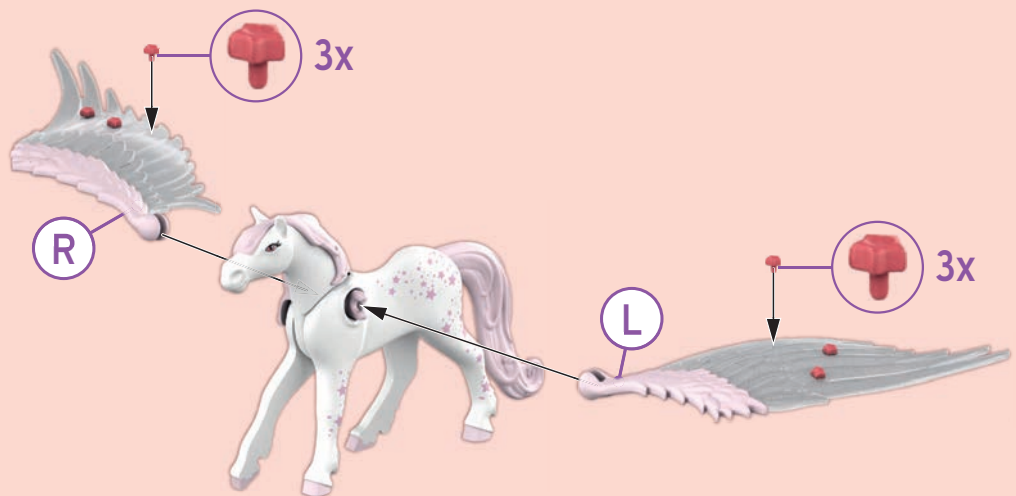

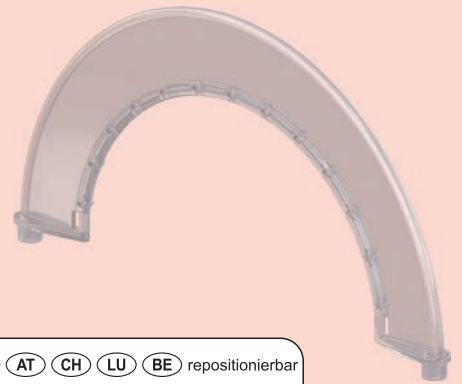

| | | | | | |
|----|----|----|----|----|--------------------|
| DE | AT | CH | LU | BE | repositionierbar |
| US | GB | CA | MT | IE | repositionable |
| FR | CA | BE | LU | CH | repositionnable |
| ES | MX | | | | reposicionable |
| NL | BE | | | | herpositioneerbaar |
| IT | CH | | | | riposizionabile |

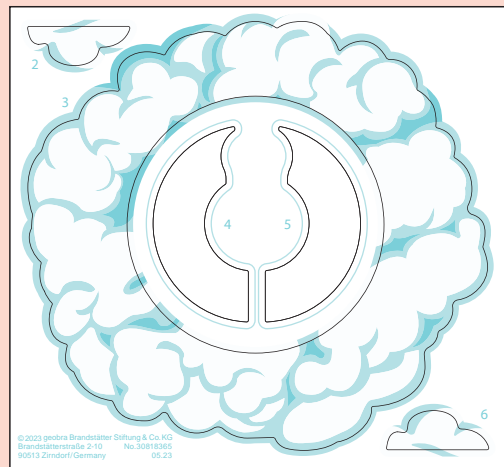

1



2

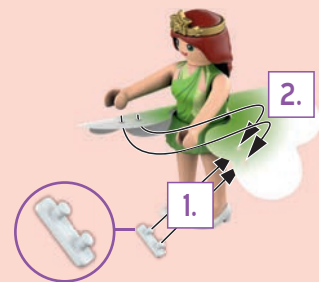
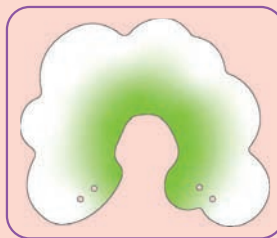

1



2

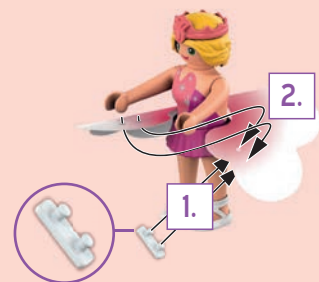
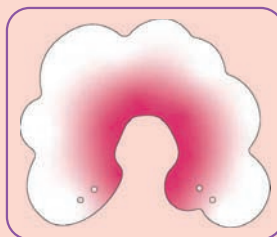



2

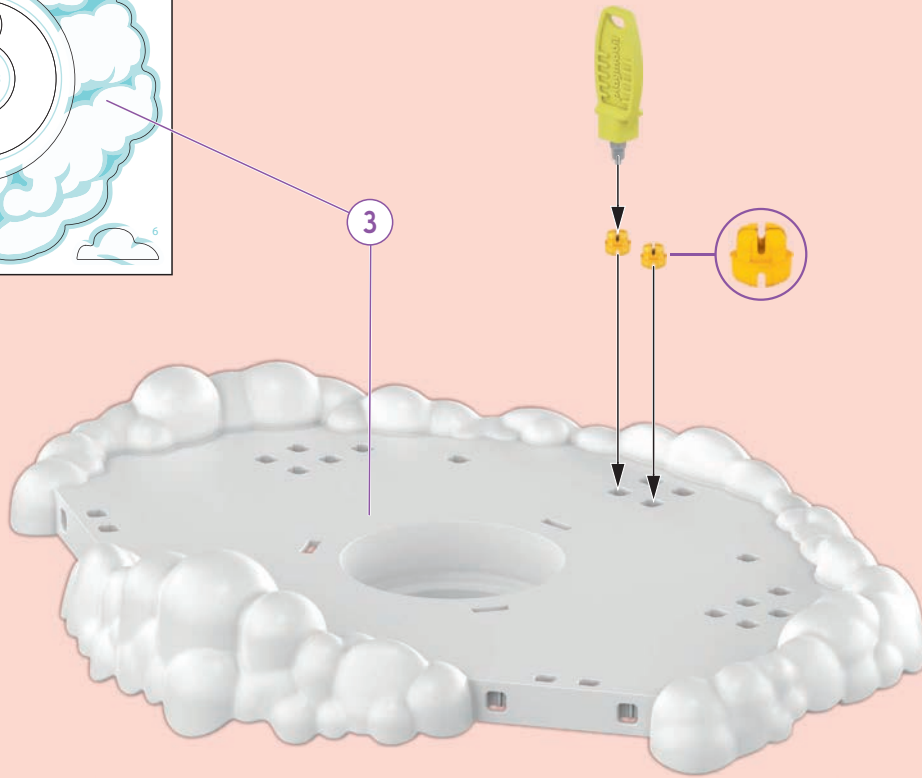
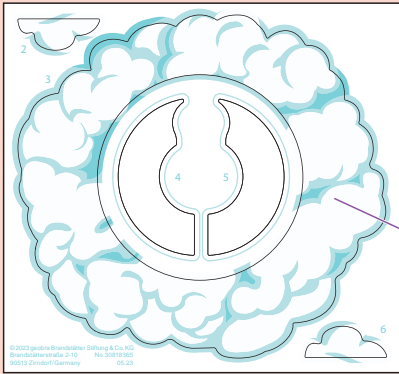

3



4

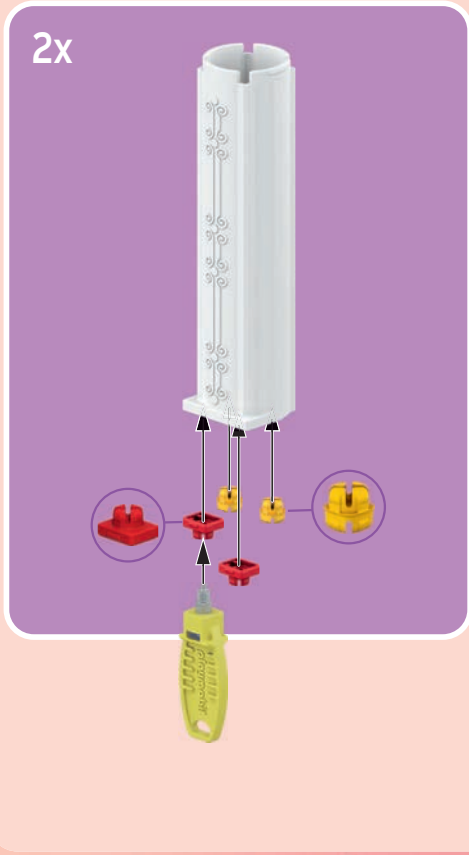

5

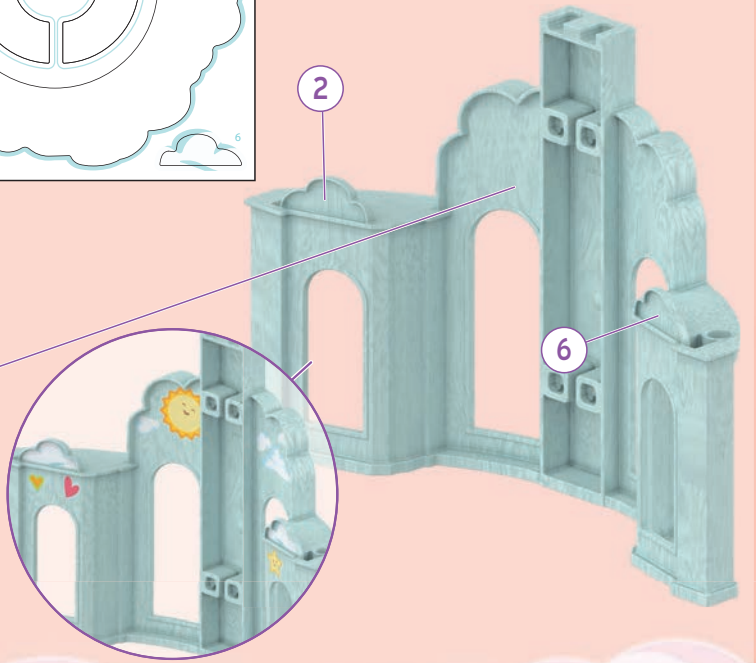
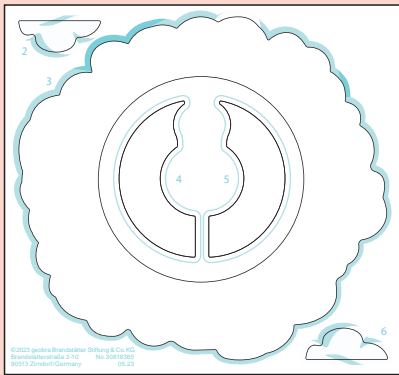

6

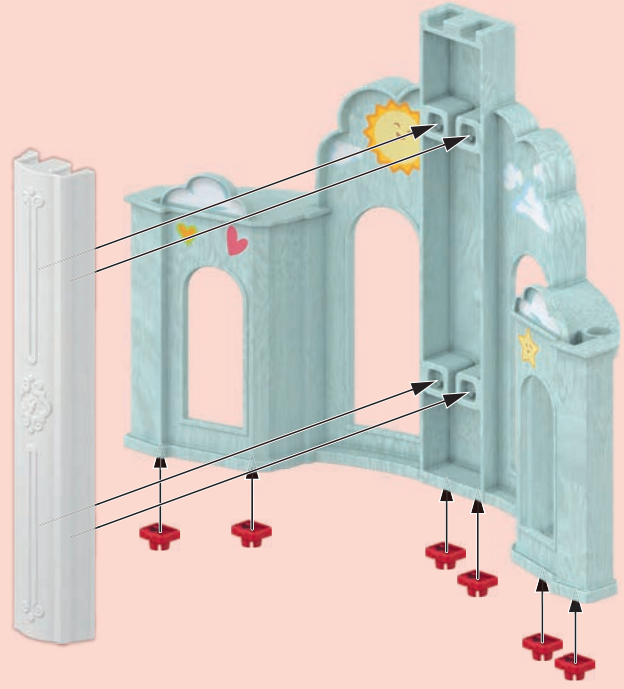
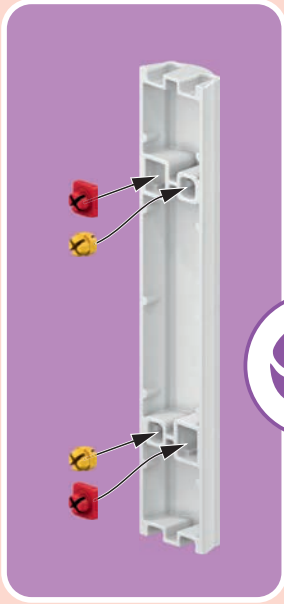

7



8

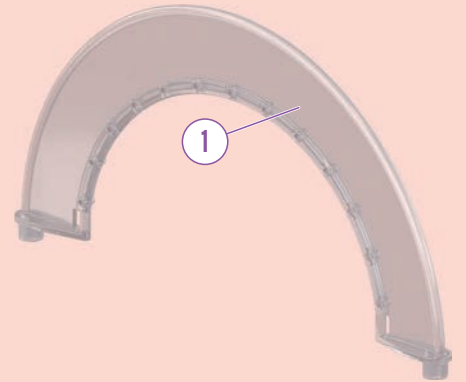

9



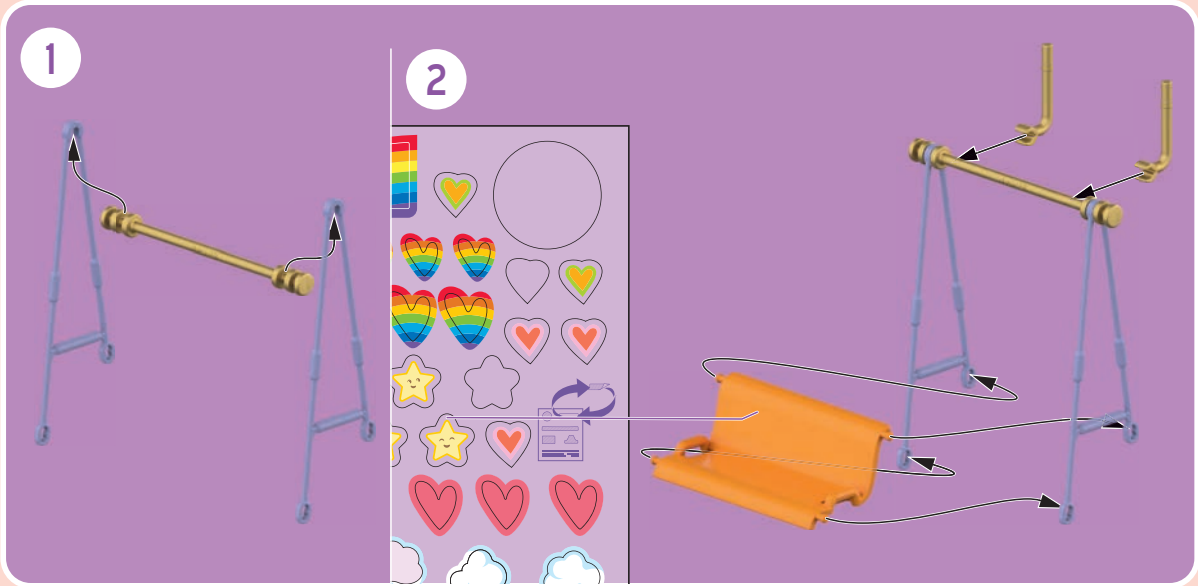





1

3x MICRO 1,5V
R03 - LR03 - AAA

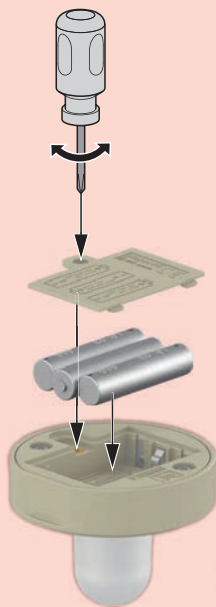

2

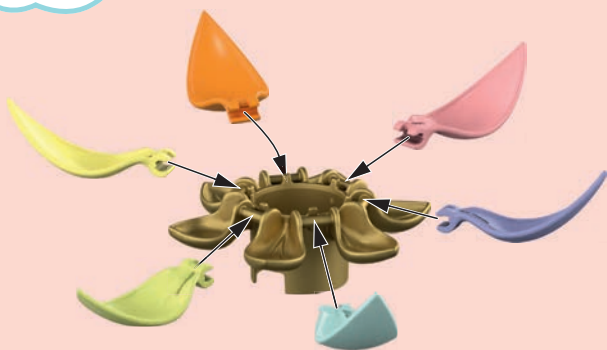
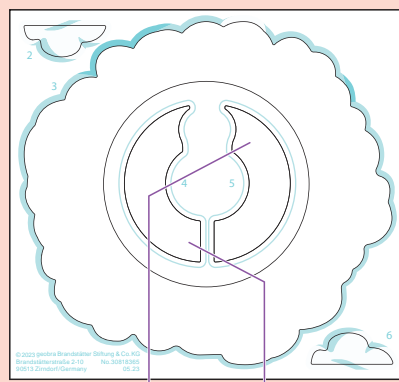

AN / AUS
ON / OFF
MARCHE / ARRÊT





(DE AT CH LU BE) ACHTUNG! Das Spielzeug erzeugt Lichtblitze, die bei empfindlichen Personen Epilepsie auslösen können.

(US GB CA MT IE) WARNING! This toy produces flashes that may trigger epilepsy in sensitised individuals.

(FR CA BE LU CH) ATTENTION! Ce jouet crée des flashes lumineux susceptibles de déclencher des crises d'épilepsie chez certaines personnes.

(ES MX) ¡ADVERTENCIA! El juguete genera destellos de luz que, en personas sensibles, pueden provocar epilepsia.

(NL BE) WAARSCHUWING! het speelgoed veroorzaakt lichtflitsen, die bij gevoelige personen epilepsie kunnen veroorzaken.

(IT CH) AVVERTENZA! Il giocattolo genera lampi di luce che possono provocare epilessia nei soggetti sensibili.

(PT) ATENÇÃO! O brinquedo imite raios de luz que, em caso de pessoas sensíveis pode provocar epilepsia.

(DK) ADVARSEL! Dette legetøj frembringer lysglimt, der kan fremprovokere epileptiske anfald hos særlig følsomme mennesker.

(NO) ADVARSEL! Leketøyet fremkaller lynlys som kan utløse epilepsi hos ømfintlige personer.

(SE FI) VARNING! Den här leksaken avger ljusblixtar, som kan utlösa epilepsi hos känsliga personer.

(FI) VAROITUS! Lelu välkyy ja voi aiheuttaa epilepsia-kohtauksen herkimille henkilöille.

(HU) FIGYELMEZTETÉS! A játékszer fényfelvillanásokat okoz, amely az arra érzékeny személyeknél epilepsziás rohamokat válthat ki!

(CZ) UPOZORNĚNÍ! Hračka vydává světelné záblesky, které mohou u citlivých osob vyvolat epilepsii.

(EE) HOIATUS! Mänguasi tekitab valgusvälkatusi, mis võivad tundlikel inimestel vallandada epileptilisi hoogusid.

(LV) BRĪDINĀJUMS! Rotaļlietai darbojoties, rodas gaismas zibšņi, kas var izraisīt epilepsijas lēkmi jutīgām personām.

(LT) ĮSPĖJIMAS! Žaislas generuoja šviesos blyksnius, kurie jautriems asmenims gali sukelti epilepsiją.

(SI) OPOZORILO! Igrača oddaja bliske, ki pri občutljivih osebah lahko lahko sprožijo epileptične napade.

(SK) UPOZORNENIE! Hračka vytvára záblesky svetla, ktoré môžu u citlivých osôb vyvolať epilepsiu.

(PL) OSTRZEŻENIE! Zabawka wytwarza błyski, które u osób wrażliwych mogą wywoływać napady epilepsji.

(TR CY) ΔΙΚΚΑΤ! Oyuncak, hassas kişilerde epilepsi nöbetine neden olabilecek ışık flaşları oluşturmaktadır.

(GR CY) ΠΡΟΕΙΔΟΠΟΙΗΣΗ! Το παιχνίδι παράγει αστραπιαίο φως που μπορεί να προκαλέσει επιληψία σε ευαίσθητα άτομα.

(RO) AVERTISMENT! Jucăria produce pulsuri de lumină care pot declanșa crize de epilepsie la persoanele sensibile.

(BG) Внимание! Играчката произвежда светкавици, които могат да предизвикат епилепсия при чувствителни лица.

(HR) UPOZORENJE! Igračka proizvodi bljeskove koji kod osjetljivih osoba mogu izazvati epilepsiju.

(RU) Внимание! игрушка генерирует вспышки света, которые могут вызвать эпилептический припадок у чувствительных людей.

(CN) 警告! 本玩具产生闪光, 在敏感者有导致癫痫发作的可能。



(IT CH) Partecipiamo alla protezione dell'ambiente!

- Il vostro apparecchio è composto da diversi materiali che possono essere riciclati.
- Lasciatelo in un punto di raccolta o presso un Centro Assistenza Autorizzato.

(PT) Protecção do ambiente em primeiro lugar!

- O seu produto contém materiais que podem ser recuperados ou reciclados.
- Entregue-o num ponto de recolha para possibilitar o seu tratamento.

(DK) Vi skal alle være med til at beskytte miljøet!

- Apparatet indeholder mange materialer, der kan genvindes eller genbruges.
- Bring det til et specialiseret indsamlingssted for genbrug eller et autoriseret serviceværksted, når det ikke skal bruges mere.

(SE FI) Var rädd om miljön!

- Din apparat innehåller olika material som kan återanvändas eller återvinnas.
- Lämna den på en återvinningsstation eller på en auktoriserad serviceverkstad för omhändertagande och behandling.

(FI) Huolehtikaamme ympäristöstä!

- Laitteesi on varustettu monilla arvokkailla ja kierrätettävillä materiaaleilla.
- Toimita laitteesi keräyspisteeseen tai sellaisen puuttuessa vaikka valtuutettuun huoltokekkukseen, jotta laitteen osat varmasti kierrätetään.

(HU) Első a környezetvédelem!

- Az Ön terméke értékes újrahasznosítható anyagokat tartalmaz.
- Kérjük készülékét ne dobja ki, hanem adja le az erre a célra kijelölt gyűjtőhelyen.

(CZ) Podílejme se na ochraně životního prostředí!

- Váš přístroj obsahuje čtené zhodnotitelné nebo recyklovatelné materiály.
- Světe jej sběrnému místu nebo, neexistuje-li, smluvnímu servisnímu středisku, kde s ním bude naloženo odpovídá jím způsobem.

(SI) Sodelujmo pri varovanju okolja!

- Vaš aparat vsebuje številne dele, ki imajo svojo vrednost ali jih je še mogoče uporabiti.
- Oddajte ga na mestu za zbiranje odpadkov ali pa na pooblaščenem servisu, da bo šel v predelavo.

(SK) Podieľajme sa na ochrane životného prostredia!

- Váš prístroj obsahuje čtené zhodnotiteľné alebo recyklovateľné materiály.
- Zveďte ho sběrnému místu alebo, ak neexistuje, zmluvnému servisnému stredisku, kde s ním bude naložené zodpovedajúcim spôsobom.

(PL) Bierzmy czynny udział w ochronie środowiska!

- Twoje urządzenie jest zbudowane z materiałów, które mogą być poddane ponownemu przetworzeniu lub recyklingowi.
- W tym celu należy je dostarczyć do wyznaczonego punktu zbiórki.

(GR CY) Ας συμβάλλουμε κι εμείς στην προστασία του περιβάλλοντος!

- Η συσκευή σας περιέχει πολλά αξιοποιήσιμα ή ανακυκλώσιμα υλικά.
- Παραδώστε την παλιά συσκευή σας σε κέντρο διαλόγησης ή σε ένα εξουσιοδοτημένο κατάστημα σέρβις.

(RO) Țineți cont de protecția mediului!

- Aparatul dvs. conține materii prime valoroase care pot fi revalorificate.
- Din acest motiv vă rugăm să predați aparatul dvs. la un centru de colectare din orașul sau comuna dvs.

(BG) Мислете за околната среда!

- Вашият уред съдържа ценни суровини, които могат да бъдат рециклирани.
- Затова върнете своя електроуред на специално място за събиране на такива отпадъци във Вашия град или община.

(RU) Подумайте о защите окружающей среды!

- Ваше устройство содержит ценное сырье, которое может быть переработано.
- Поэтому, пожалуйста, верните ваше устройство в пункт сбора в вашем городе или муниципалитете.

(CN) 环保第一! 设备含有可回收和可再循环的有价值的材料, 将其放回当地的市政垃圾收集点。

(DE AT CH LU BE) Denken Sie an den Schutz der Umwelt!

- Ihr Gerät enthält wertvolle Rohstoffe, die wieder verwertet werden können.
- Geben Sie Ihr Gerät deshalb bitte bei einer Sammelstelle Ihrer Stadt oder Gemeinde ab.

(GB MT IE) Environment protection first!

- Your appliance contains valuable materials which can be recovered or recycled.
- Leave it at a local civic waste collection point.

(FR LU CH) Participons à la protection de l'environnement !

- Votre appareil contient de nombreux matériaux valorisables ou recyclables.
- Confiez celui-ci dans un point de collecte pour que son traitement soit effectué.

(ES) ¡¡ Participe en la conservación del medio ambiente !!

- Su electrodoméstico contiene materiales recuperables y/o reciclables.
- Entréguelo al final de su vida útil, en un Centro de Recogida Específico o en uno de nuestros Servicios Oficiales Post Venta donde será tratado de forma adecuada.

(NL BE) Samen het milieu beschermen!

- Uw product bevat meerdere recycleerbare materialen
- Breng deze naar een afvalinzamelpunt.

(BE) Participons à la protection de l'environnement!

- Votre appareil contient de nombreux matériaux valorisables ou recyclables.
- Confiez celui-ci dans un point de collecte ou à défaut dans un centre service agréé pour que son traitement soit effectué.

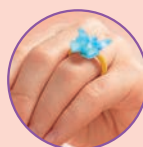
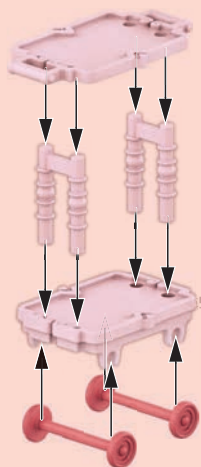

2x



30 02 2595



2x 30 02 2395



30 25 8600



2x 30 02 2405



30 02 1655



30 02 2605



30 66 0256



30 51 5233

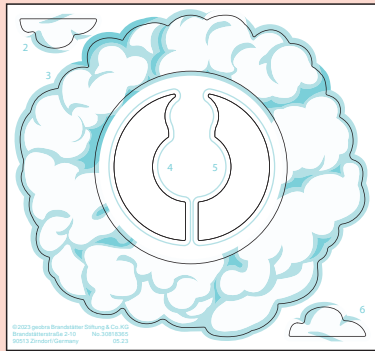

30 81 8365



30 81 8355



14x 30 03 6600



16x 30 09 6900



6x

30 51 5543



30 65 8822

30 02 3314



30 02 2705



30 14 7932



30 02 2615



30 21 3072



30 14 7922



30 64 5018

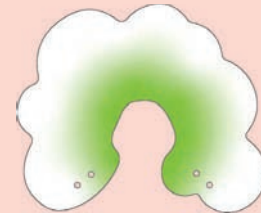

30 64 5038



2x 30 08 5584



30 02 2695



30 02 2685



30 02 2665



3x 30 02 2445



3x 30 29 5510



2x 30 02 2715



2x 30 02 2675



30 02 2725



3x 30 21 3123



30 25 7530



30 25 4283



2x 30 02 2735



2x 30 02 2745



30 80 8823



30 02 2755

30 02 2775



30 02 2765



30 02 2785



30 02 2825



30 02 2815



30 02 2835



30 02 2805



30 02 2795



30 02 2895



30 51 5243



2x 30 08 3653



2x 30 21 3712



30 09 9842



30 02 2915



30 02 2905



2x 30 02 2875



30 02 2885



30 21 8360



30 22 9322



30 02 2935



30 02 2925



2x 30 22 2303

Serviceadressen finden Sie in allen PLAYMOBIL-Prospekten

Addresses of Customer Service Departments are shown in all PLAYMOBIL catalogues

L'adresse du service consommateurs est indiquée dans tous les catalogues PLAYMOBIL

Troverete gli indirizzi dei centri di assistenza in tutti i cataloghi PLAYMOBIL

In alle PLAYMOBIL catalogi vindt u het adres van onze klantendienst.

Las Direcciones de los Departamentos de Servicio al Consumidor se encuentran en todos los catálogos PLAYMOBIL

Η διεύθυνση του Γραφείου Εξυπηρέτησης Καταναλωτών PLAYMOBIL βρίσκεται σε όλους τους καταλόγους PLAYMOBIL.

pronounced: plāy-mō-bēēl

US

This device complies with Part 15 of the FCC Rules. Operation is subject to the following two conditions:

- (1) This device may not cause harmful interference, and
- (2) this device must accept any interference received, including interference that may cause undesired operation.

CA

CAN ICES-3 (B)/NMB-3(B)

Cet équipement est conforme à la Section 15 des règlements de la FCC. Son fonctionnement est soumis aux deux conditions suivantes:

- (1) Cet équipement ne peut causer d'interférence nuisible, et
- (2) cet équipement doit pouvoir fonctionner même s'il capte de l'interférence, incluant celle pouvant provoquer un fonctionnement indésirable.

US

NOTE: This equipment has been tested and found to comply with the limits for a Class B digital device, pursuant to part 15 of the FCC Rules. These limits are designed to provide reasonable protection against harmful interference in a residential installation. This equipment generates, uses and can radiate radio frequency energy and, if not installed and used in accordance with the instructions, may cause harmful interference to radio communications. However, there is no guarantee that interference will not occur in a particular installation. If this equipment does cause harmful interference to radio or television reception, which can be determined by turning the equipment off and on, the user is encouraged to try to correct the interference by one or more of the following measures:

- Reorient or relocate the receiving antenna.
- Increase the separation between the equipment and receiver.
- Connect the equipment into an outlet on a circuit different from that to which the receiver is connected.
- Consult the dealer or an experienced radio/TV technician for help.

PLAYMOBIL USA, INC.

26 Commerce Drive
Cranbury, NJ 08512
Phone 1-800-752-9662 or 609-395-5566
Email: service@playmobilusa.com

Caution: Changes or modifications not expressly approved by the party responsible for compliance could void the user's authority to operate the equipment.

UK-Importer:
Playmobil UK Ltd.
Regency House
1 Miles Gray Road
Basildon · Essex
SS14 3RW · UK

**UK
CA**



FR

**DONNEZ
OU
RECYCLEZ**



ASSOCIATION



MAGASIN



LIVRAISON



DÉCHÈTERIE

Adresses sur quefairedemesdechets.fr

71359 + 71360 + 71408



71408

71359

71360



71363



71361

✓ 71359



71360



71408



71364



71362



Scan mich
Scan me
Scannez-moi
Escanea



Erkunde das Regenbogenschloss und lerne seine magischen Geschöpfe kennen! Scanne den QR-Code und tauche ein in die Welt von Princess Magic!

Explore the Rainbow Castle and meet its mythical creatures! Scan the QR code and enter the world of Princess Magic!

Découvre la tourelle enchantée et ses habitants ! Scanne le QR code pour plonger dans le monde des princesses magiques !

¡Explora el Castillo Arcoíris en las Nubes y conoce criaturas mágicas! ¡Escanea el código QR y entra al mágico mundo de las princesas!

www.playmobil.com



©2023 geobra Brandstätter Stiftung & Co. KG
Brandstätterstr. 2-10
90513 Zirndorf, Germany
No. 30 81 5725 05.23

