

playmobil®

Country



71238

NEU new
Nouveau
nuevo



Aufbauen leicht gemacht mit nummerierten Tüten.
Viel Spaß mit deinem neuen PLAYMOBIL-Spielzeug!

Set-up made easy with numbered bags.
Have fun with your new PLAYMOBIL toy!

Simplicité de montage avec les sachets numérotés.
Amuse-toi avec tes nouveaux PLAYMOBIL!

El montaje es más fácil con
las bolsas numeradas.
¡Diviértete con tu nuevo
juguete de PLAYMOBIL!





WARNING: CHOKING HAZARD

Small parts. Not for children under 3 years.

”Ne concerne que les USA“



Wichtige Unterlagen, bitte sorgfältig aufbewahren!
Important: Please keep these instructions for future reference!
Documents importants, à conserver soigneusement!
¡Por favor, guarde estas instrucciones para el futuro!
Belangrijke documenten, bewaar deze zorgvuldig!

Abbildungen können vom Original abweichen.
Product may differ from image shown.
Les illustrations peuvent différer de l'original.
Las ilustraciones pueden diferir del original.
Afbeeldingen kunnen verschillen van het
werkelijke artikel.

Serviceadressen finden Sie in allen
PLAYMOBIL-Prospekten

Addresses of Customer Service Depart-
ments are shown in all PLAYMOBIL
catalogues

L'adresse du service consommateurs
est indiquée dans tous les catalogues
PLAYMOBIL

Troverete gli indirizzi dei centri di
assistenza in tutti i cataloghi PLAYMOBIL

UK-Importer:
Playmobil UK Ltd.
Regency House
1 Miles Gray Road
Basildon
Essex
SS14 3RW
UK

**UK
CA**

In alle PLAYMOBIL catalogi vindt u
het adres van onze klantendienst.

Las Direcciones de los Departamentos
de Servicio al Consumidor se encuentran
en todos los catálogos PLAYMOBIL

Η διεύθυνση του Γραφείου Εξυπηρέτησης
Καταναλωτών PLAYMOBIL βρίσκεται σε
όλους τους καταλόγους PLAYMOBIL.

pronounced: plāy-mō-bēēl

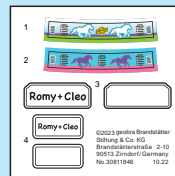

FR

**DONNEZ
OU
RECYCLEZ**



OU



OU



OU



OU

ASSOCIATION

MAGASIN

LIVRAISON

DÉCHÈTERIE

Adresses sur quefaire@emesdechets.fr

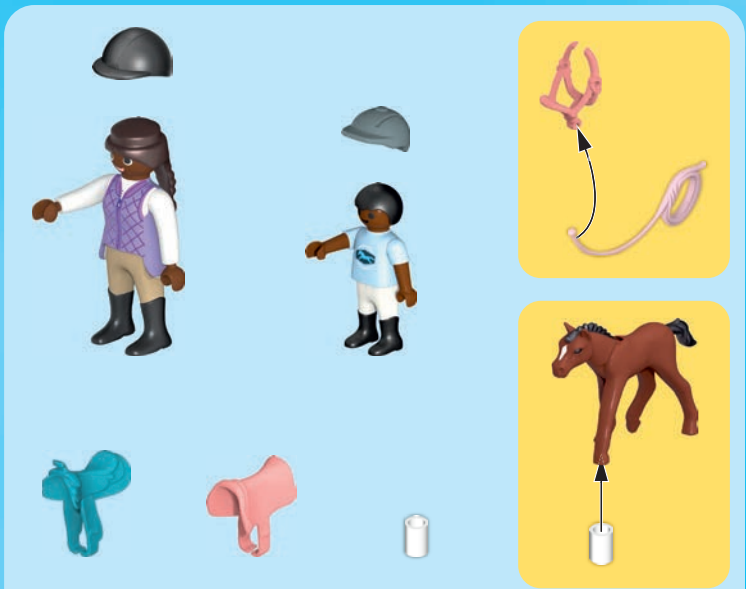
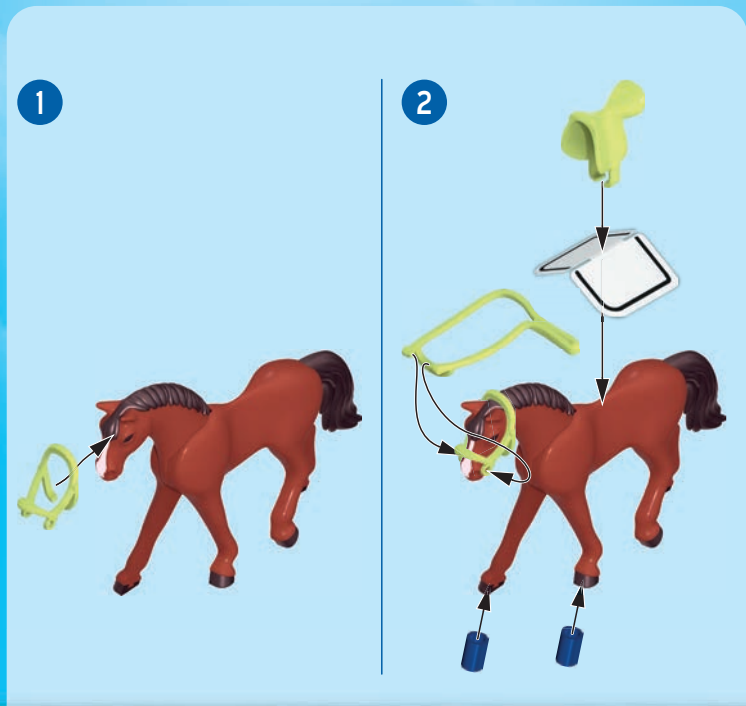



+



1

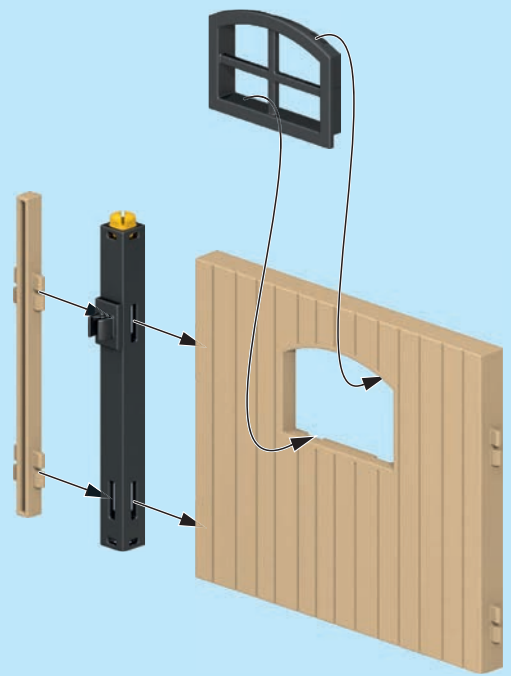
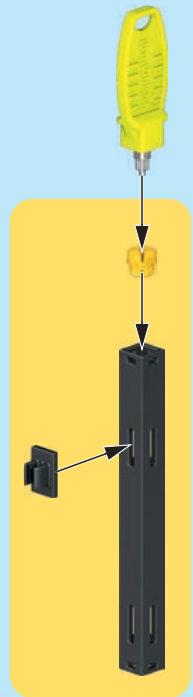

2

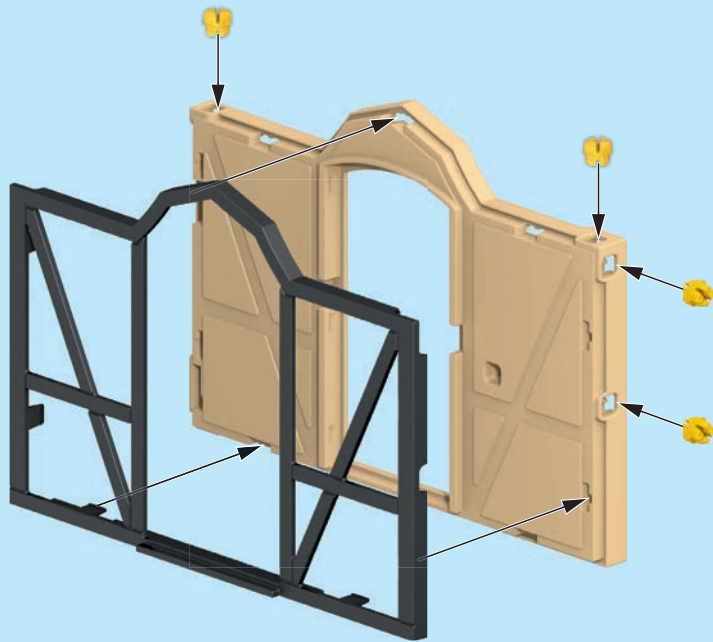

3

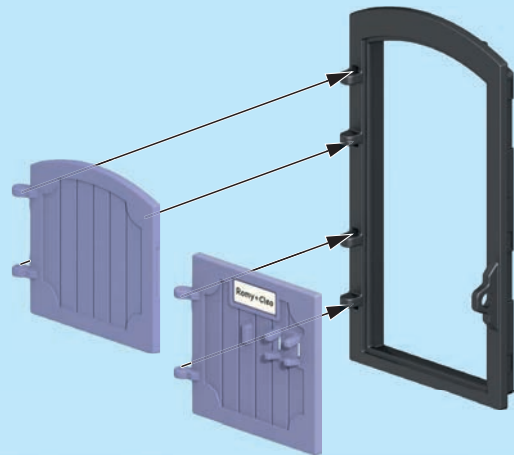
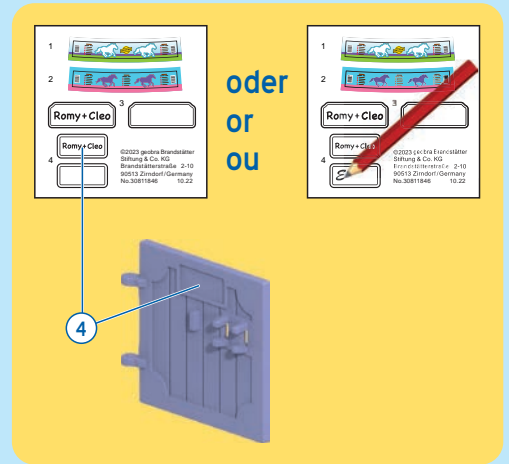

4

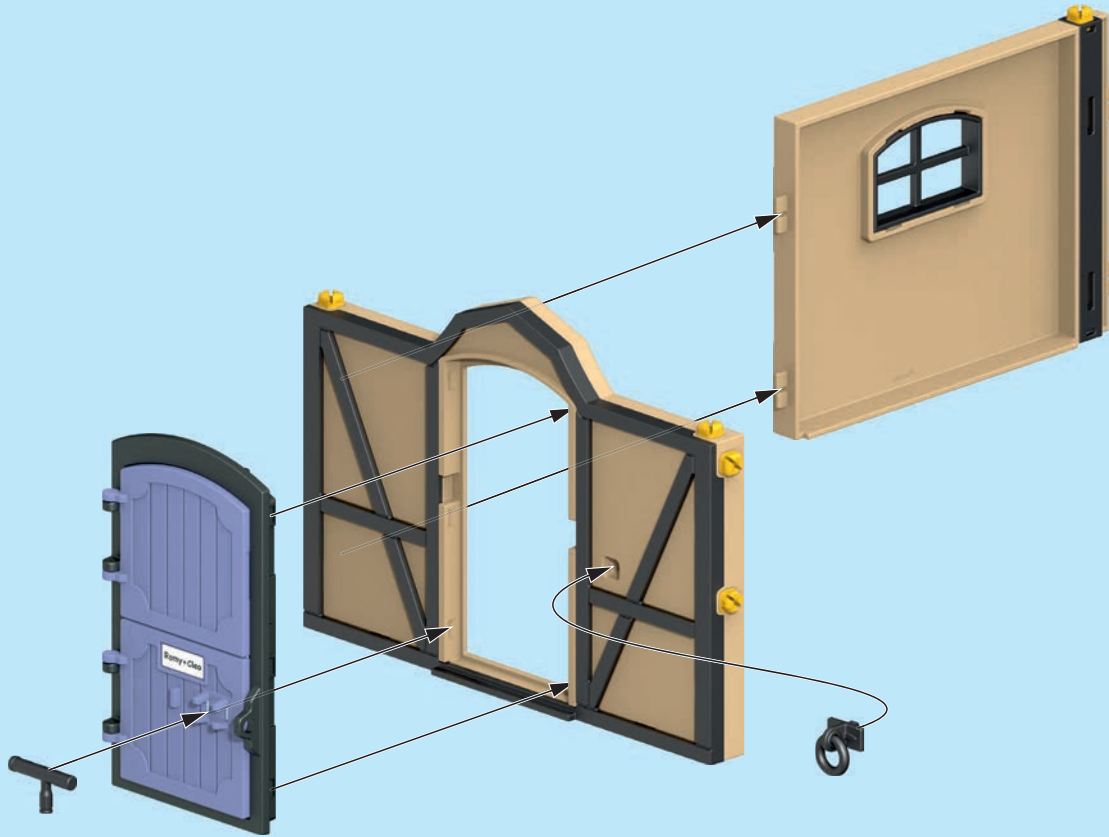

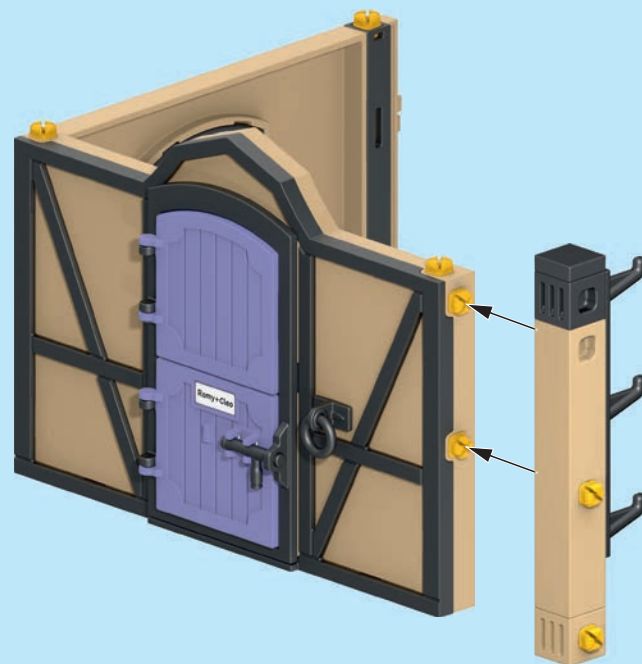
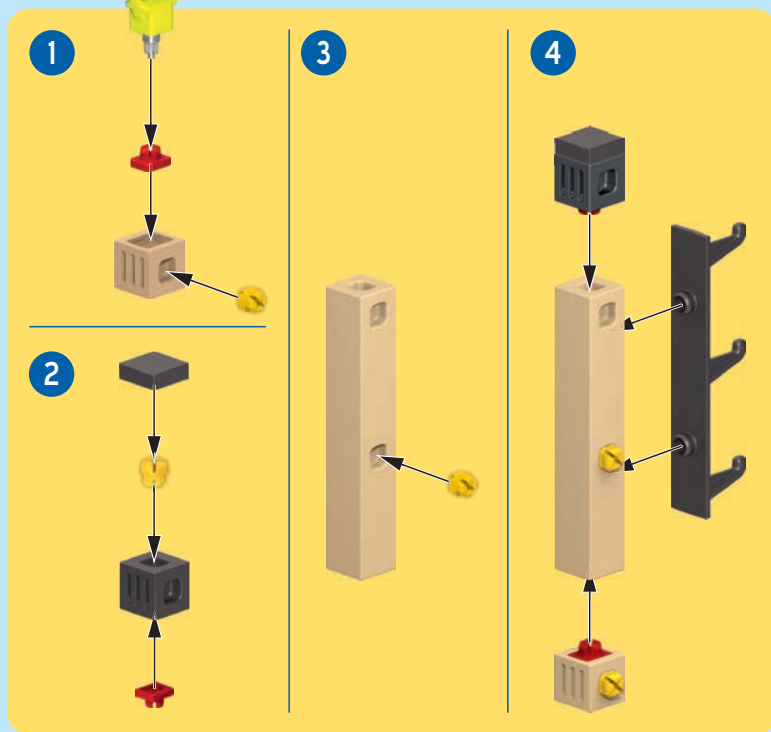

6

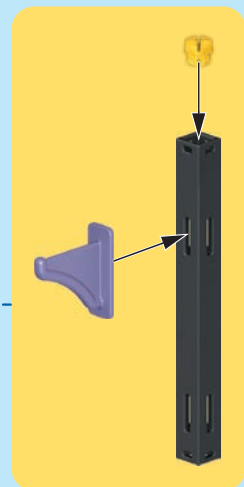
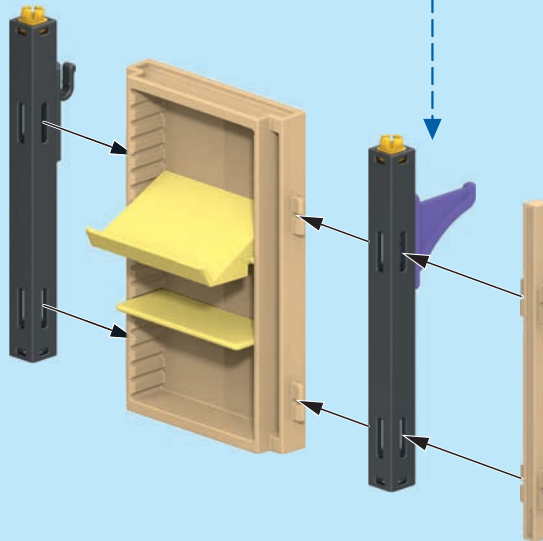
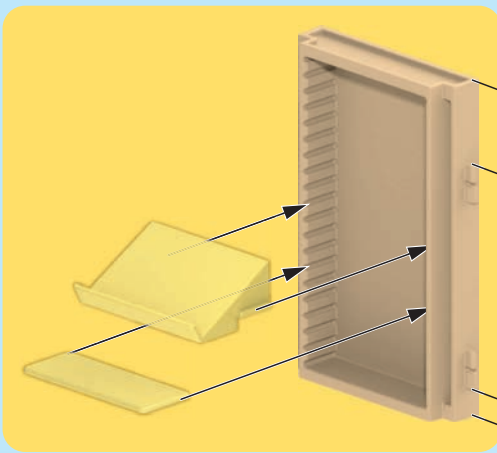
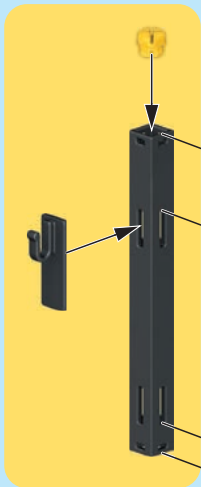

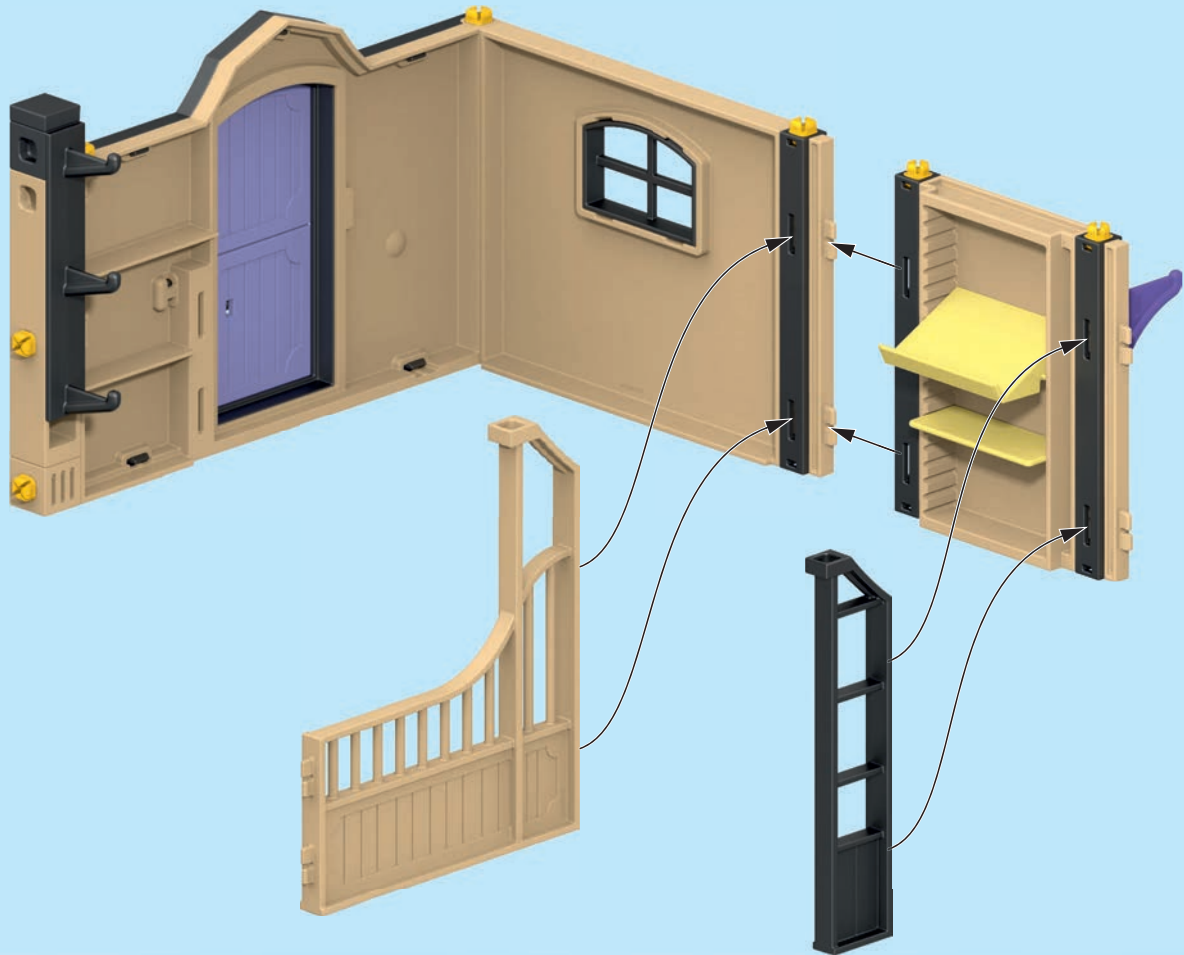

8

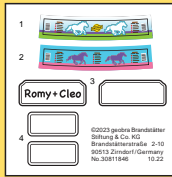

oder
or
ou

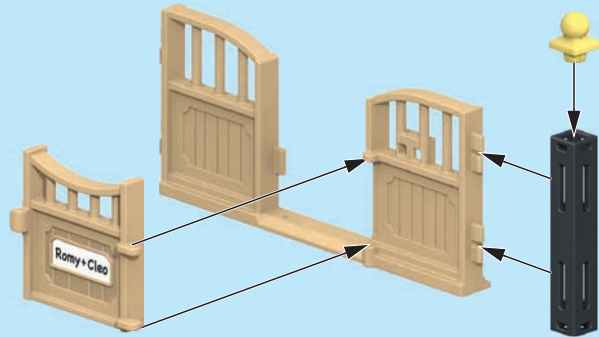
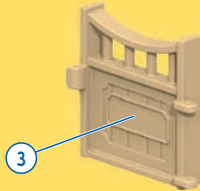
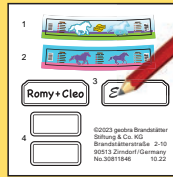

9

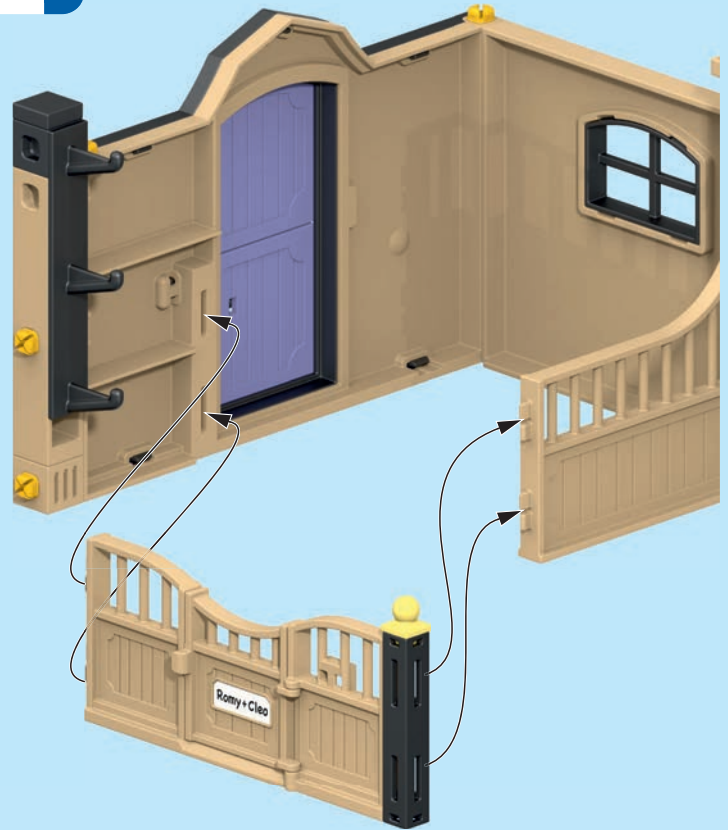

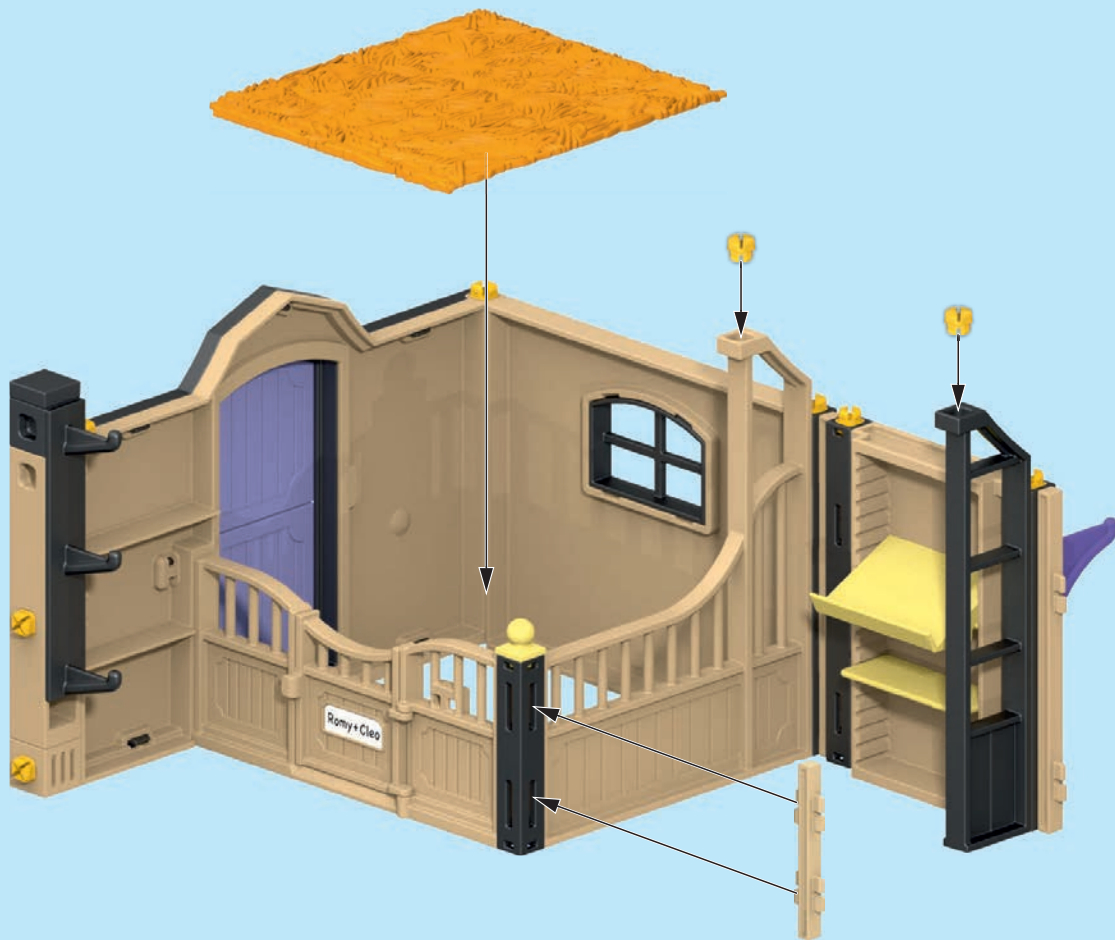

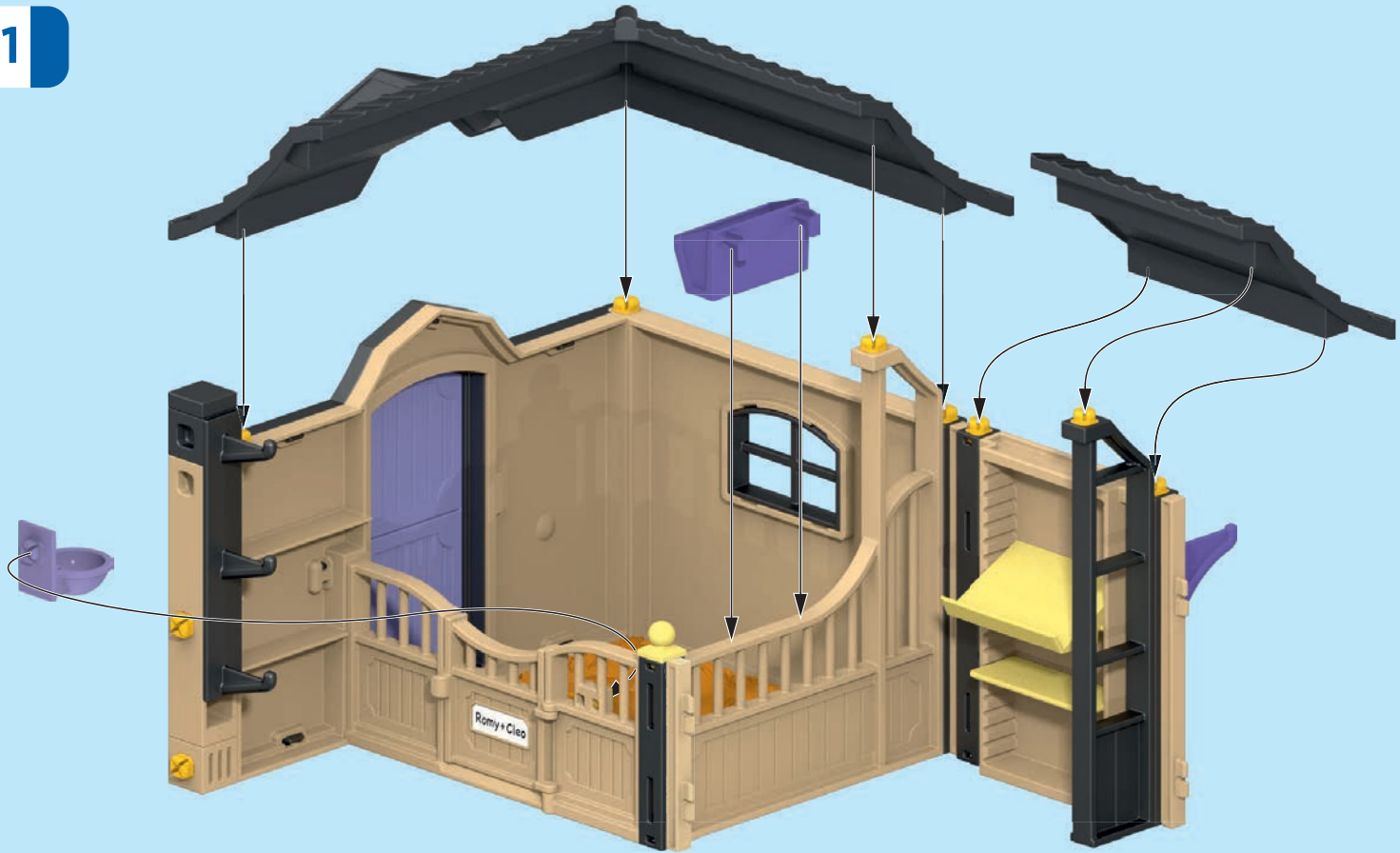

12

A vertical orange panel containing the parts list for step 12. At the top is a white bag with a green recycling symbol and the number '4'. Below it is a plus sign '+'. Underneath is a white bag with a green recycling symbol and the number '1', with a blue arrow pointing to the right. At the bottom are two black vertical posts, a metal chain, and a grey pin.

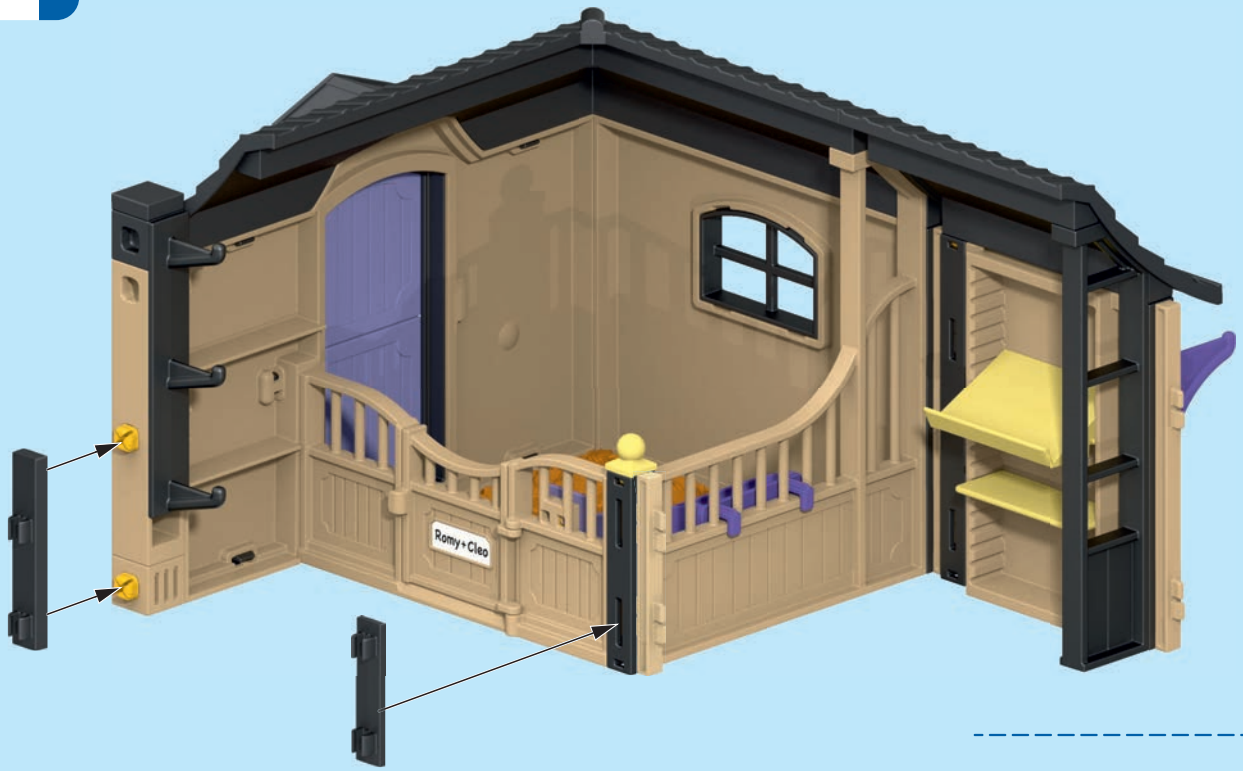

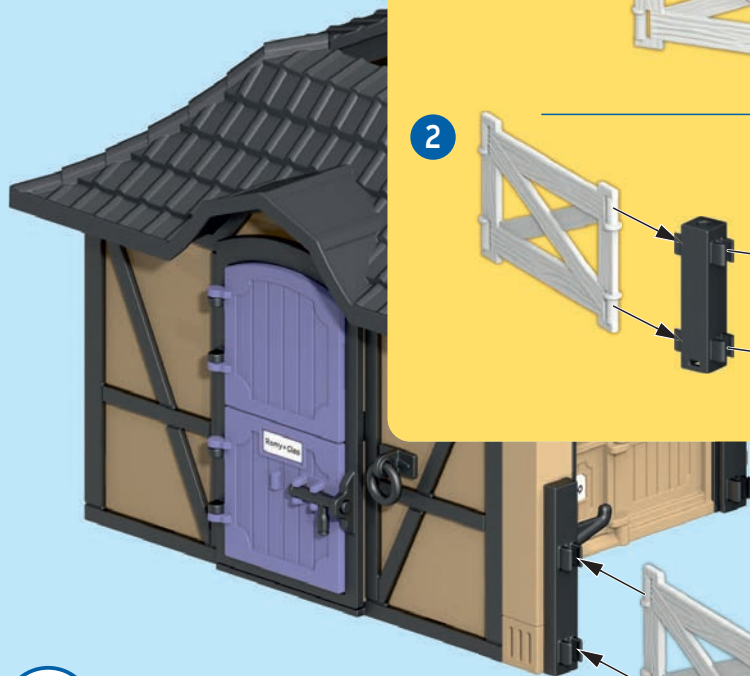

1

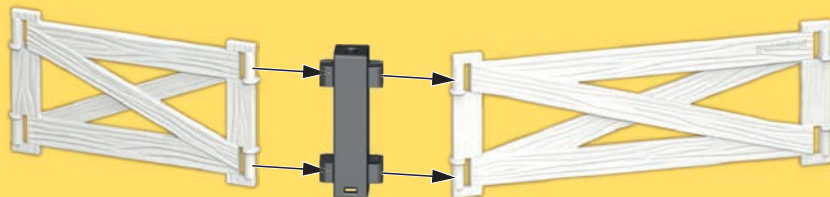

2

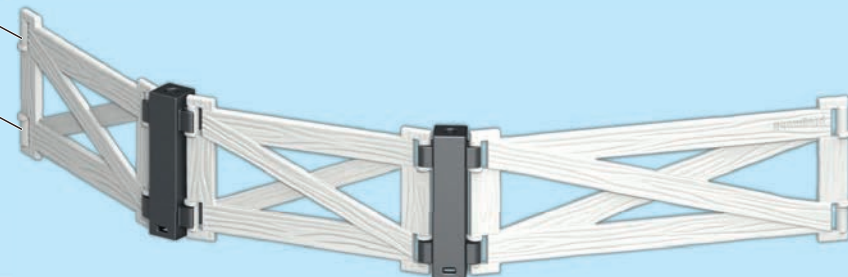
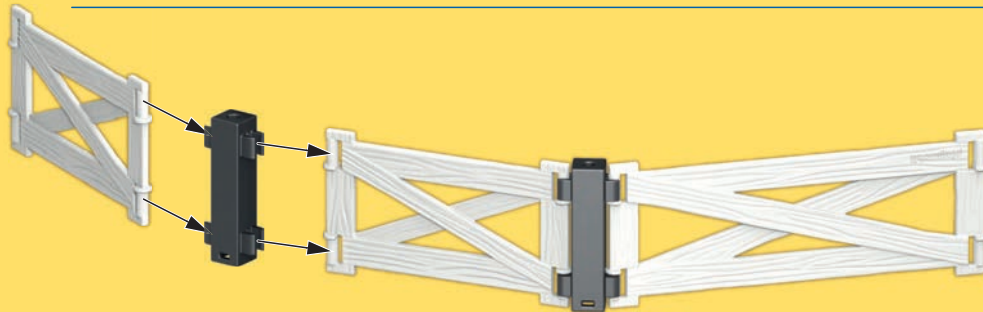



1

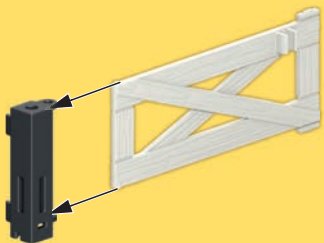

2

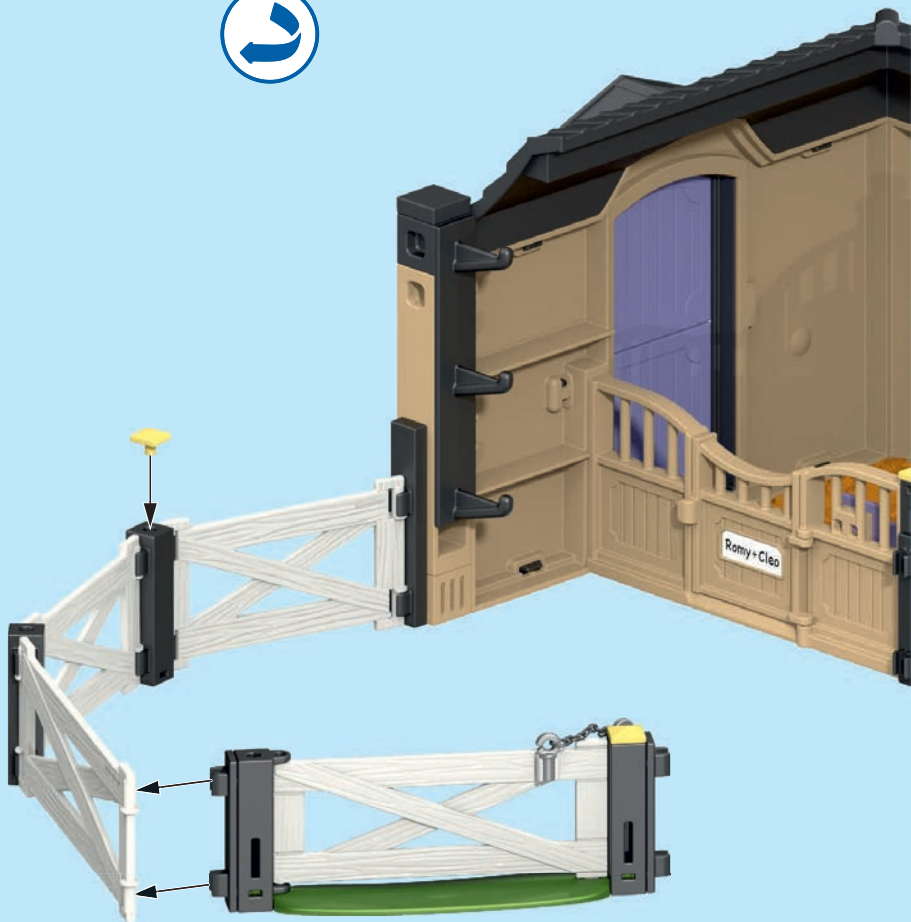
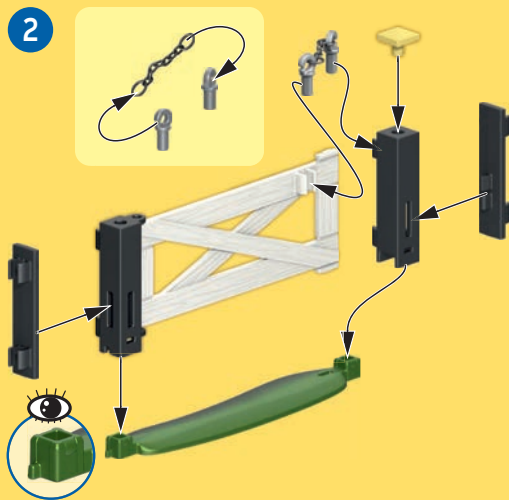

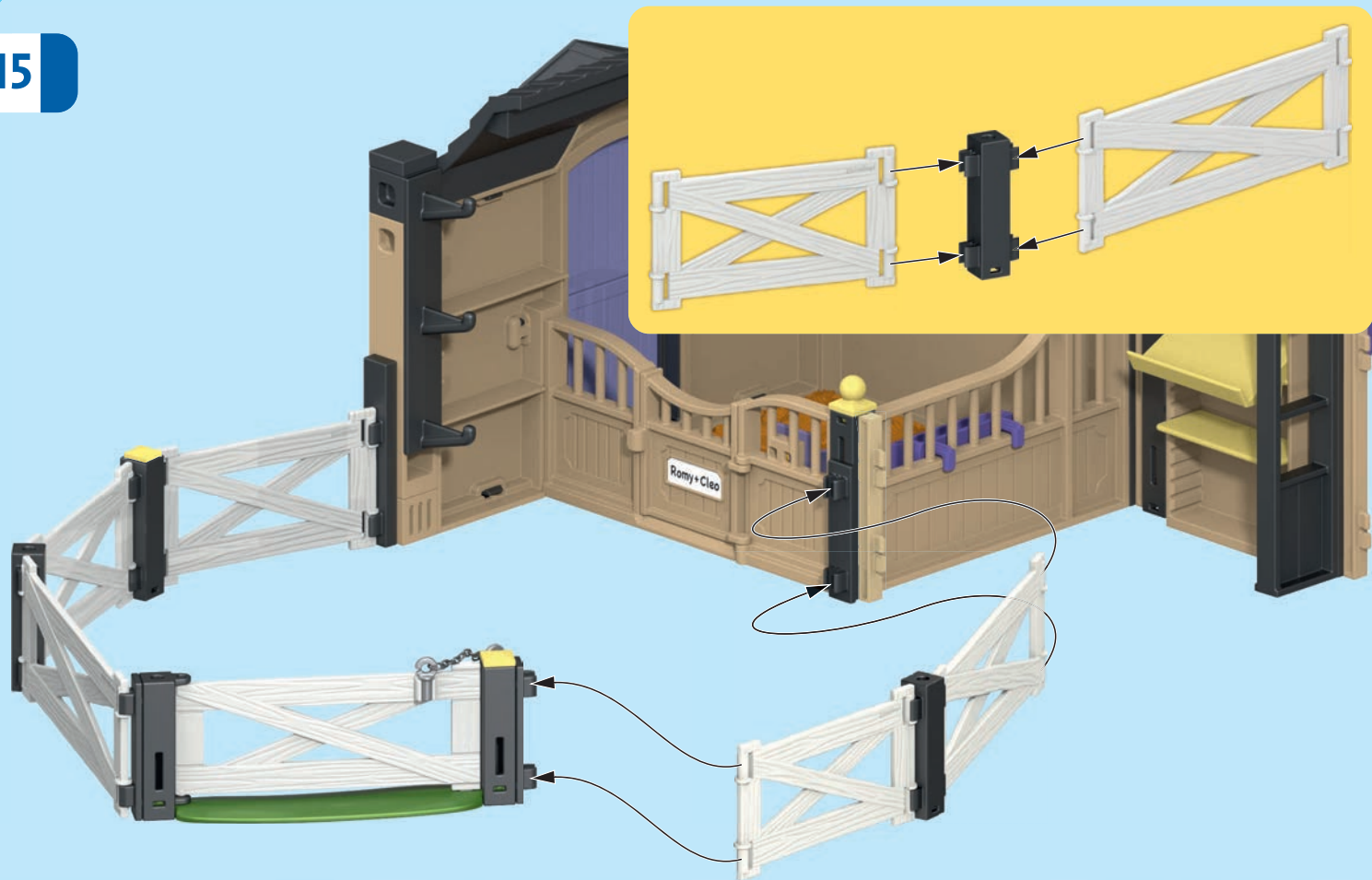





2x

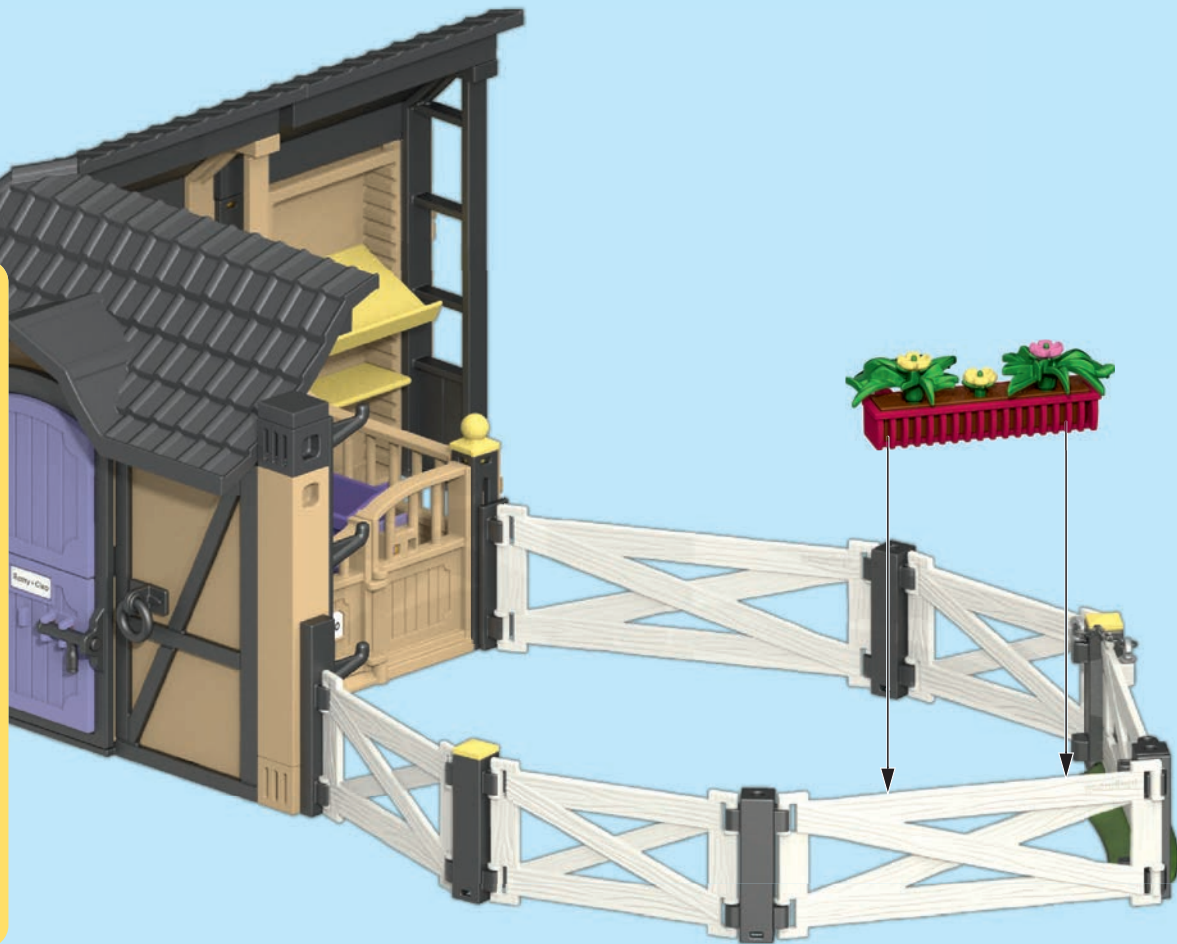
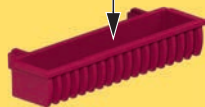



3x

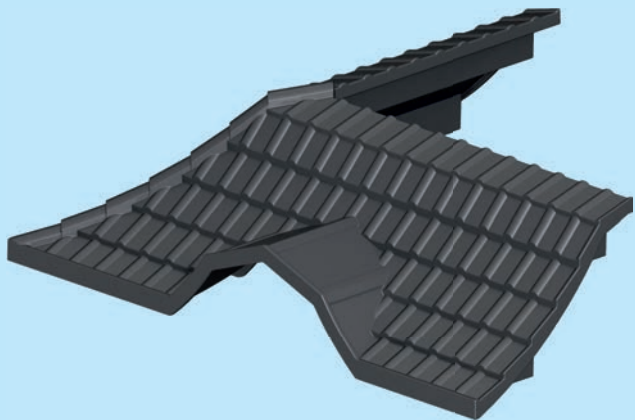

30 08 4814



30 05 1494

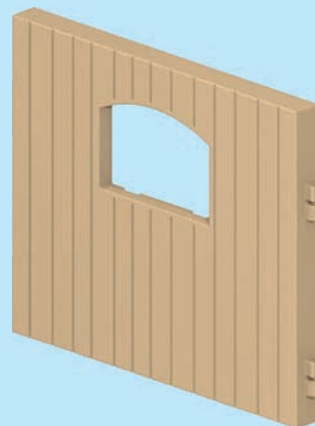

30 08 4904

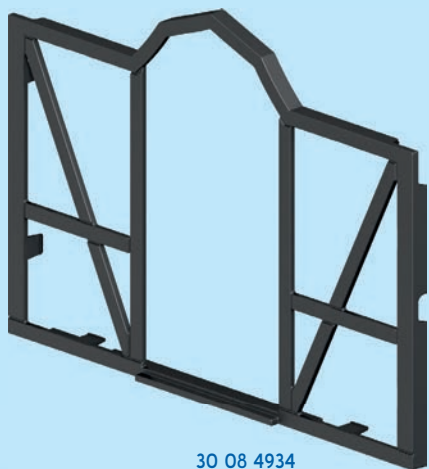

30 08 4934

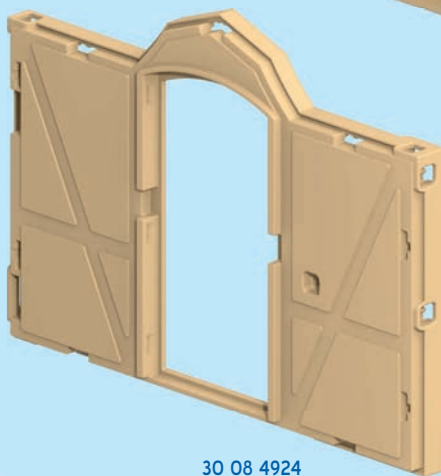

30 08 4924



30 08 4844

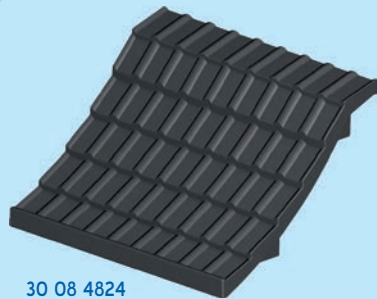

30 08 4824



30 08 4914



30 06 0142

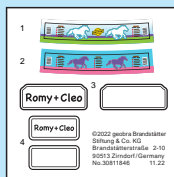

30 81 1846



30 51 3423



30 65 8822



30 21 8663



4x 30 28 7910



2x 30 02 7442



3x 30 22 9543



30 08 4294



30 21 8673



30 08 4764



30 08 4784



30 82 0163



30 02 7622



30 08 4944



30 07 2373



30 24 1352



30 05 1554



30 05 1534



30 88 0582



2x 30 20 2354



3x 30 05 1664



3x 30 08 5833



30 05 1674



30 09 9303



2x 30 08 9253



13x 30 03 6600

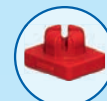

2x 30 09 6900



30 14 7332



30 67 0603



30 10 5460



30 67 0613



30 08 4724



30 08 4754



30 08 4734



30 20 3204



30 08 4714



30 08 4744



30 22 0762



30 08 4704



2x 30 82 3034



2x 30 88 8712



30 05 1524



30 05 1504



30 02 7582



2x 30 05 6762



30 06 0322



30 08 4834



3x 30 05 1484



30 06 0132



30 08 4794



30 05 6752



30 08 4804

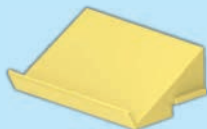

30 08 4774



30 08 4624



30 08 4884



30 08 4894



30 06 0182

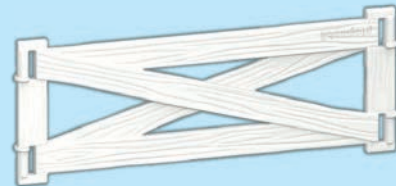

2x 30 02 7372

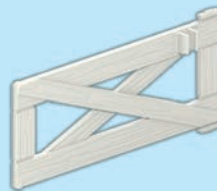

30 02 7392



3x 30 02 7382



3x 30 05 1574



30 08 4654



3x 30 05 1564



30 20 9982



30 09 7010



30 02 7522



30 08 4864



30 08 4854



30 65 7905



2x 30 05 1584



30 09 9952



30 08 4684



3x 30 21 4422



2x 30 02 6470



3x 30 22 2812



30 65 8025



30 06 0062



30 25 7052



30 06 9072



30 20 4412



30 22 3750



30 08 9713



30 25 2073



2x 30 62 1737

70238 + 70240



70238



70240





71243



71242



71241



71238



71237



71239



71240



© 2022 geobra Brandstätter Stiftung & Co. KG
 Brandstätterstr. 2-10
 90513 Zimndorf, Germany
 No. 30 82 4506 09.23

