

playmobil®

City Life



70986

**NEU new**  
Nouveau  
nuevo

Aufbauen leicht gemacht mit nummerierten Tüten. Viel Spaß mit deinem neuen PLAYMOBIL-Spielzeug!

Set-up made easy with numbered bags.  
Have fun with your new PLAYMOBIL toy!

Simplicité de montage avec les sachets numérotés.  
Amuse-toi avec tes nouveaux PLAYMOBIL!

El montaje es más fácil con las bolsas numeradas.  
¡Diviértete con tu nuevo juguete de PLAYMOBIL!



**WARNING:**  
**CHOKING HAZARD**  
Contains a small ball and small parts.  
Not for children under 3 years.

“Ne concerne que les USA”

Wichtige Unterlagen, bitte sorgfältig aufbewahren!  
Important: Please keep these instructions for future reference!  
Documents importants, à conserver soigneusement!  
¡Por favor, guarde estas instrucciones para el futuro!  
Belangrijke documenten, bewaar deze zorgvuldig!

Abbildungen können vom Original abweichen.  
Product may differ from image shown.  
Les illustrations peuvent différer de l'original.  
Las ilustraciones pueden diferir del original.  
Afbeeldingen kunnen verschillen van het werkelijke artikel.



+



1

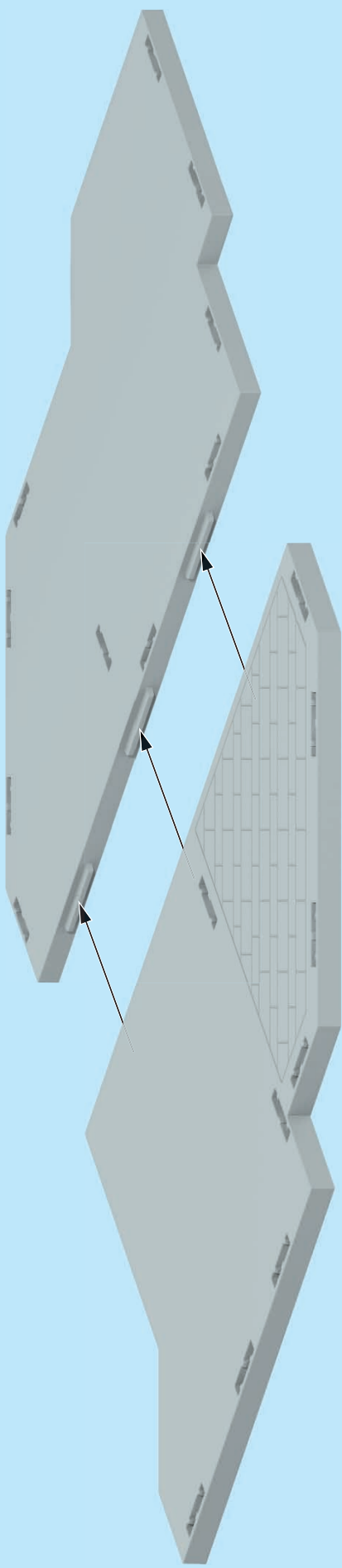

2

1

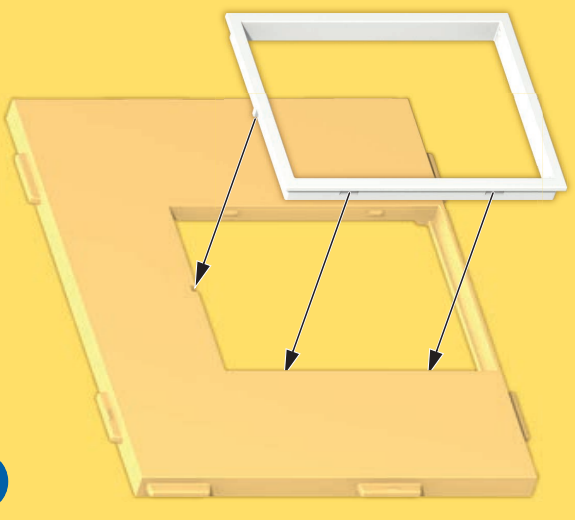

2

2x

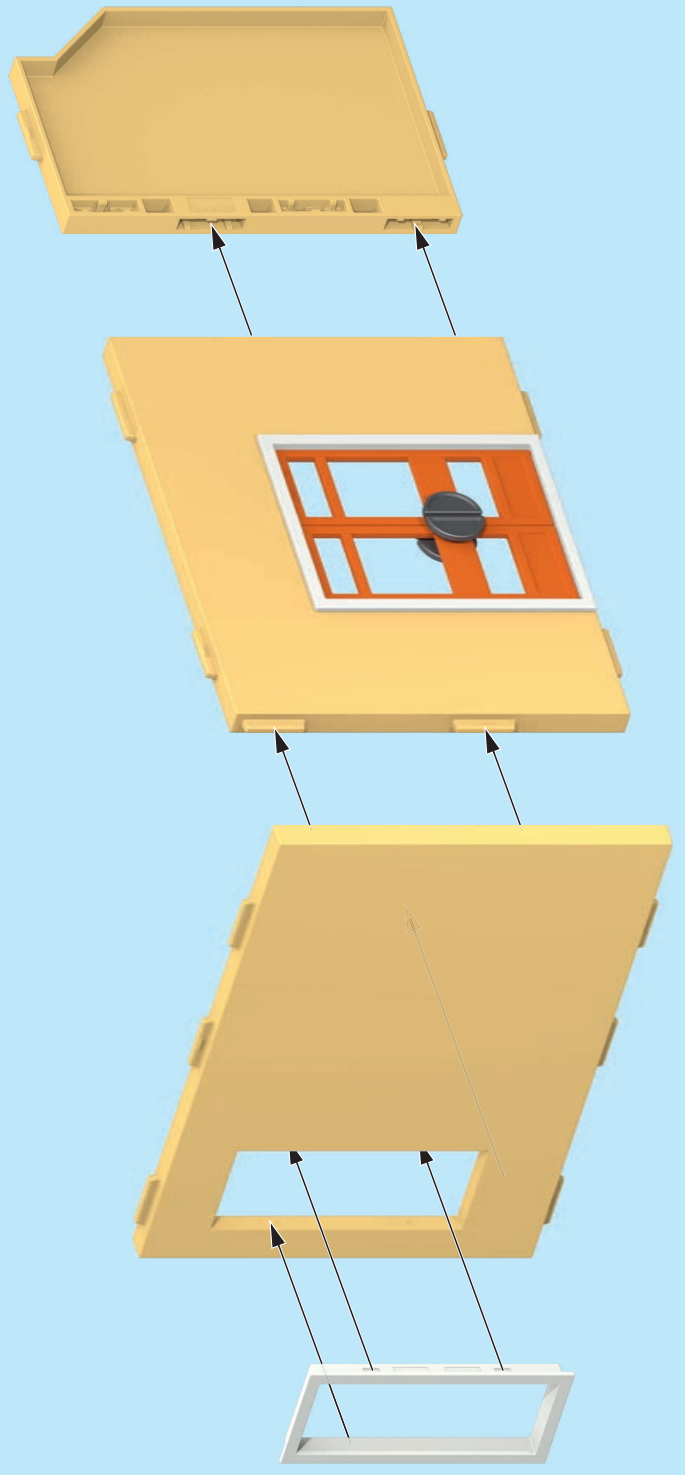
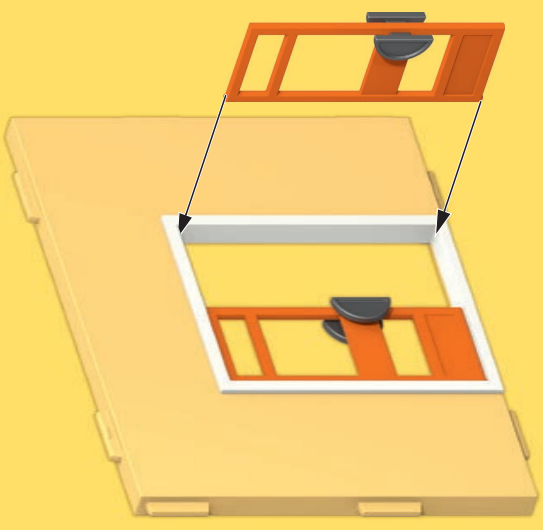
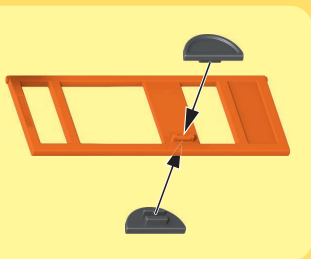

3

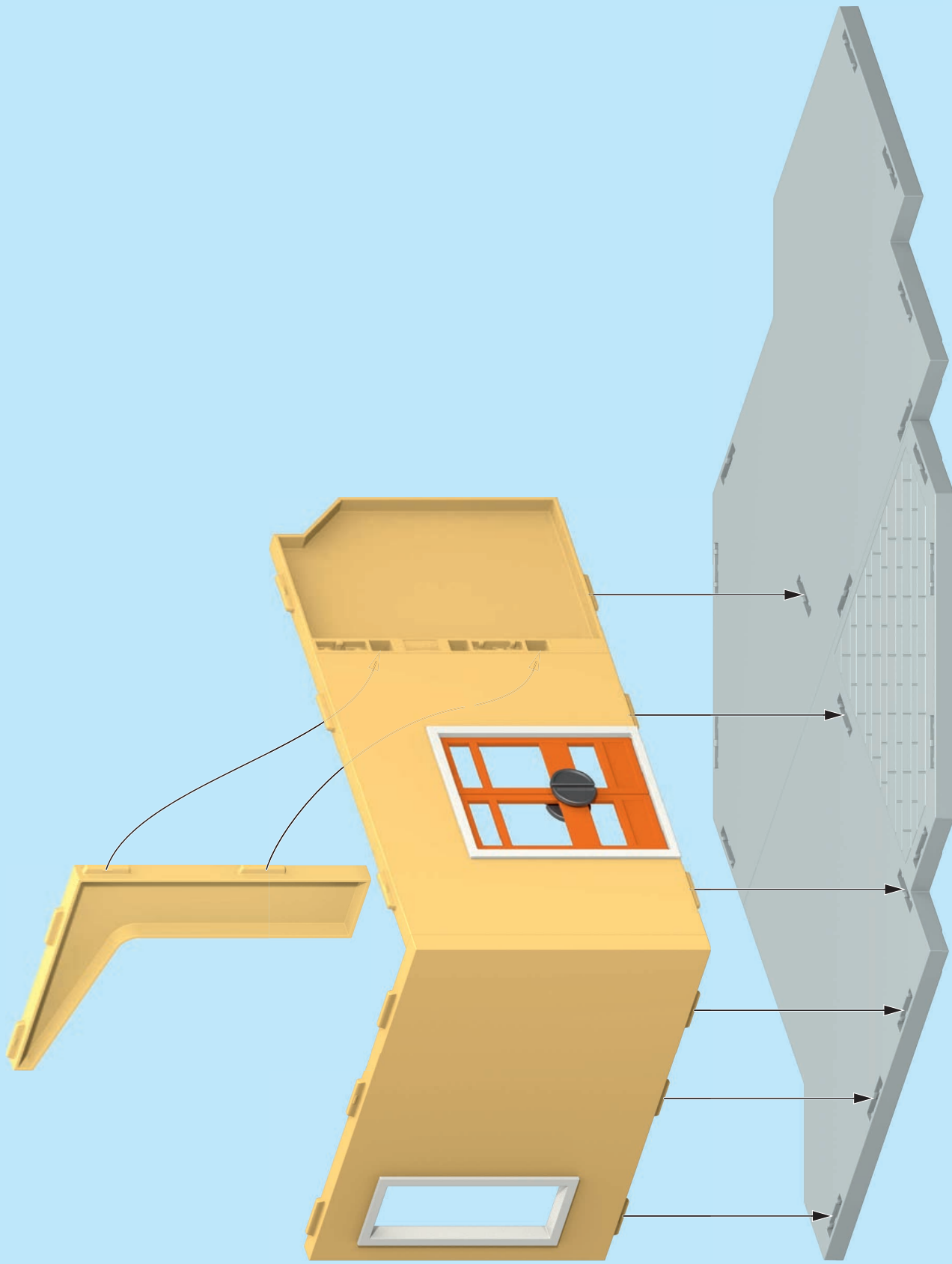

4

1

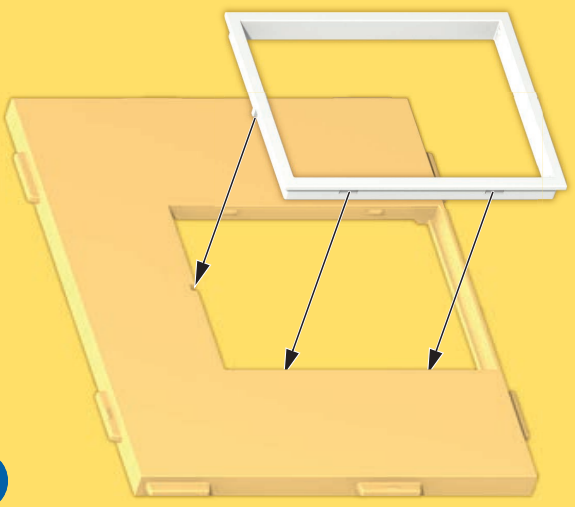

2

2x

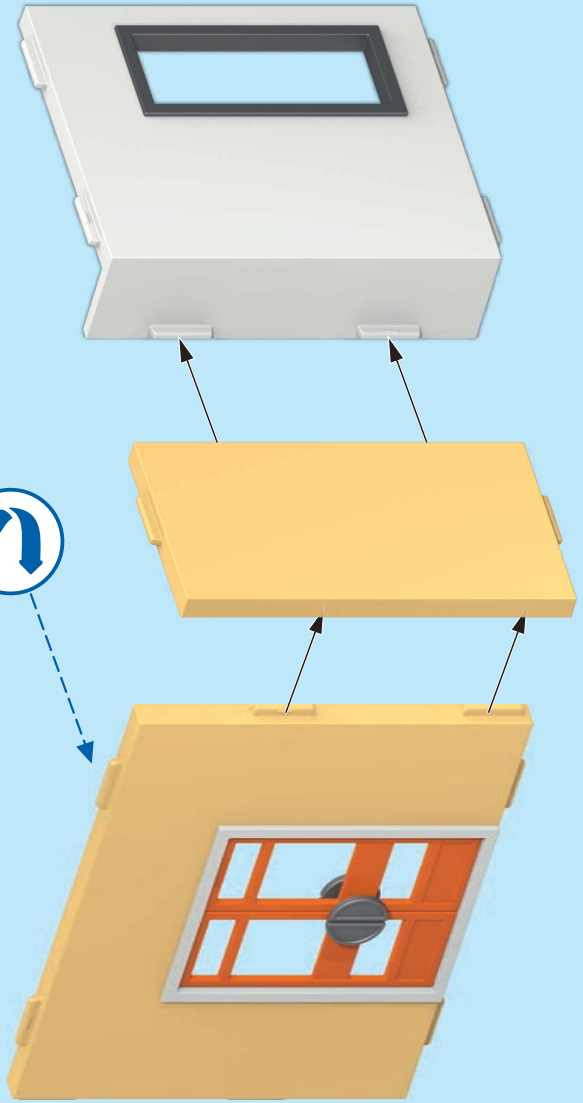
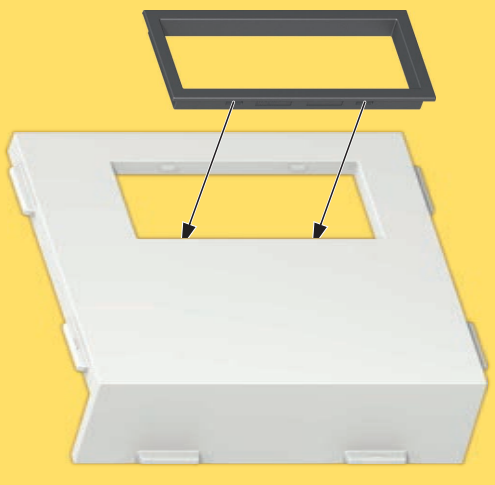
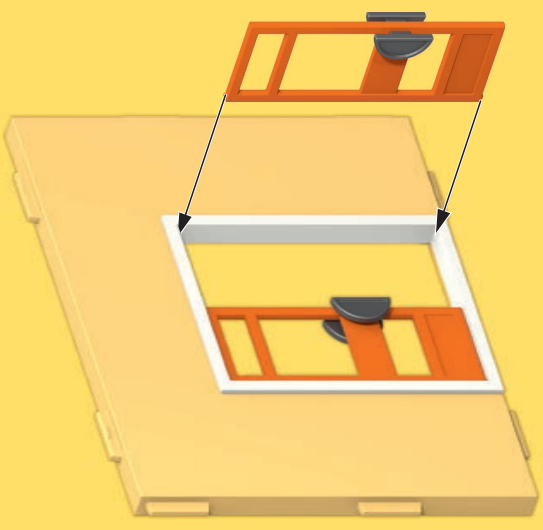
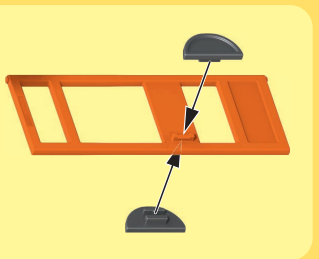

5

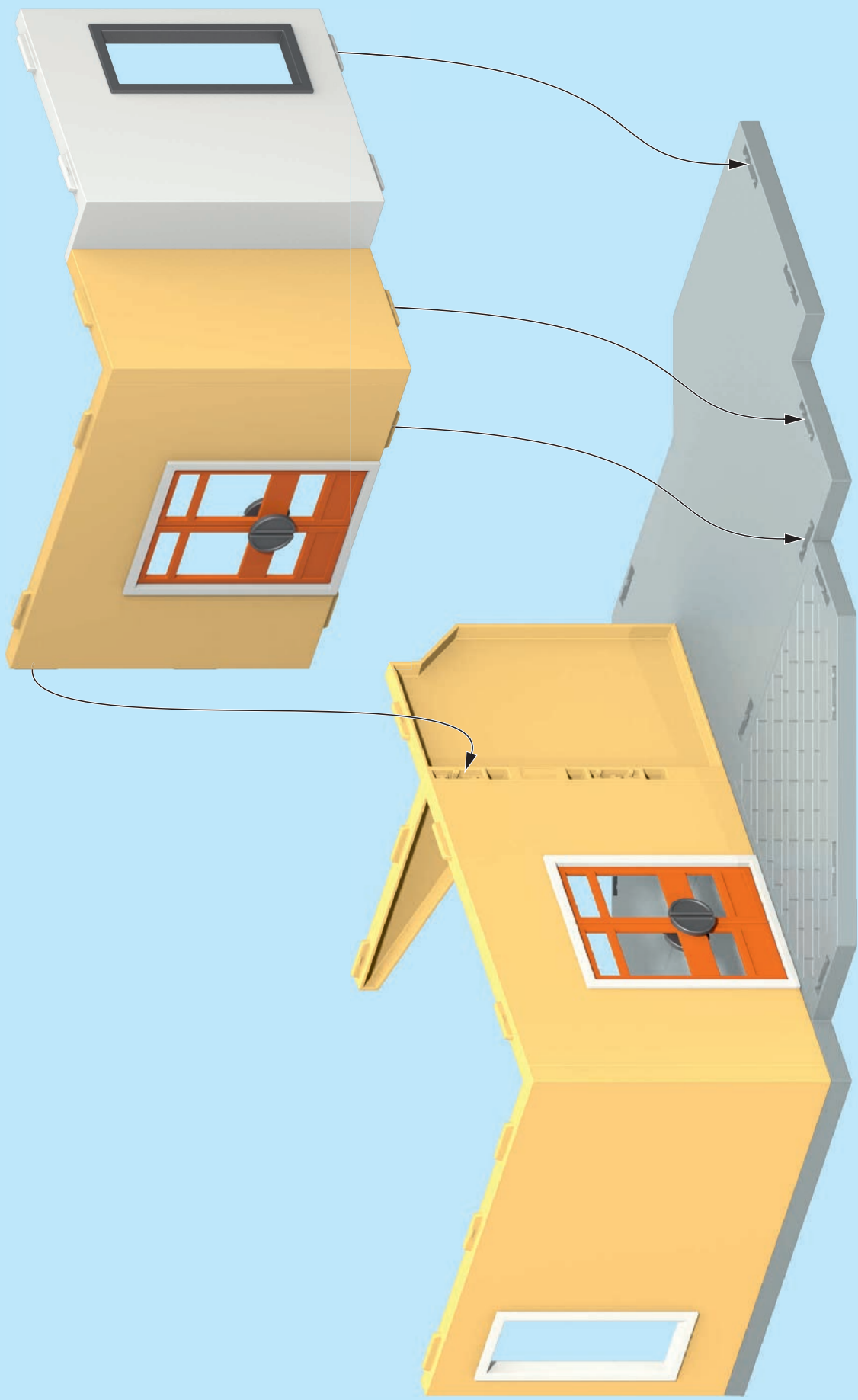

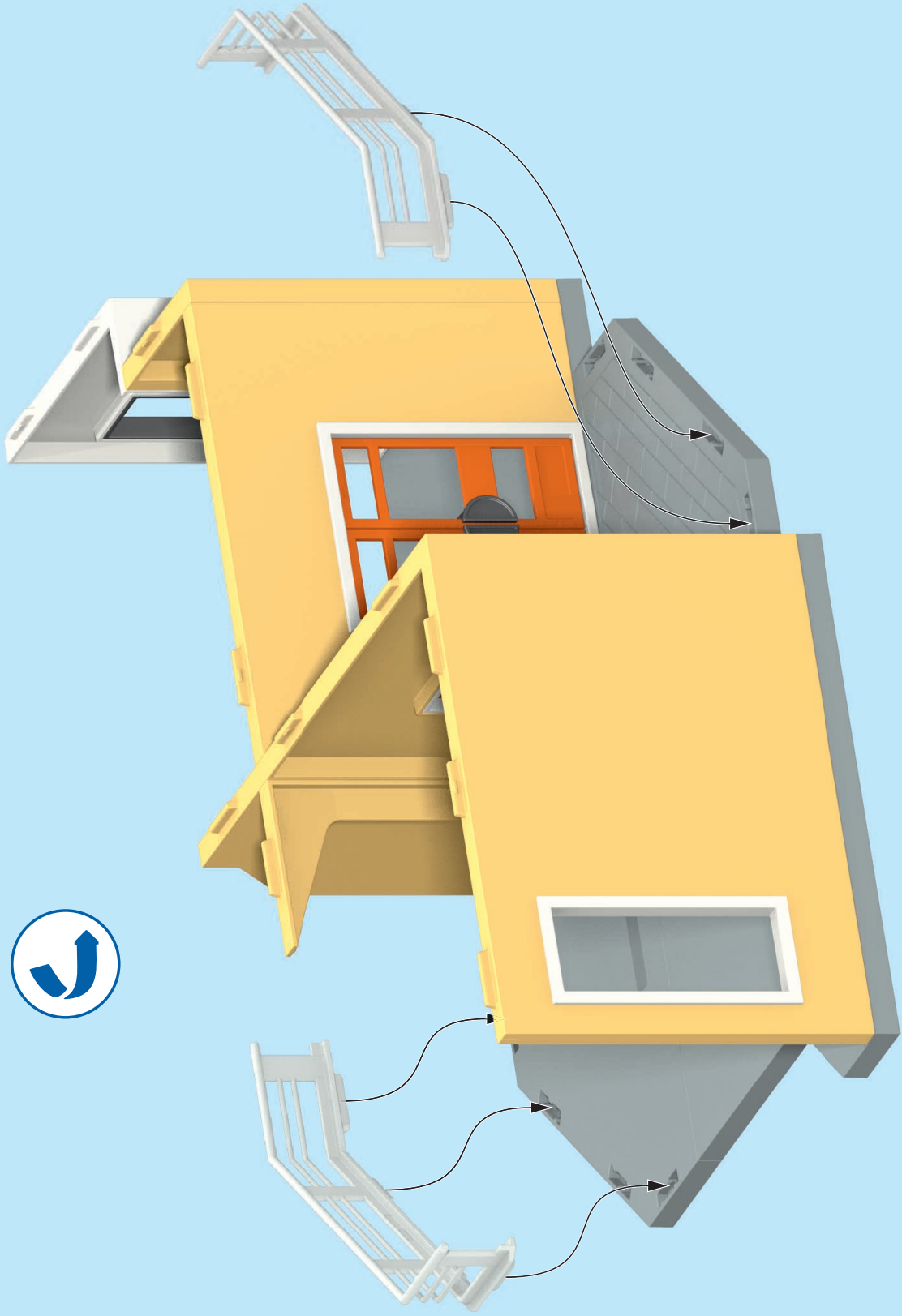

1





2

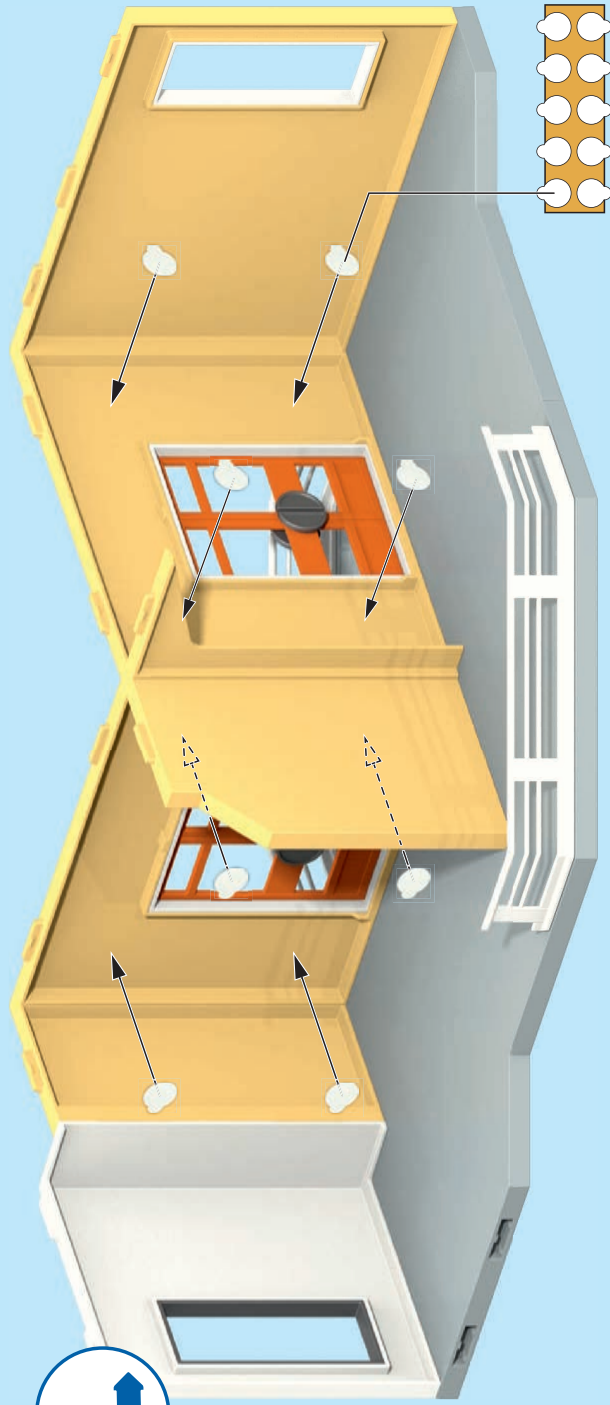

3



4



5



6

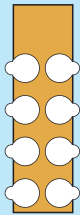

7





70986 + 9266

8

9266

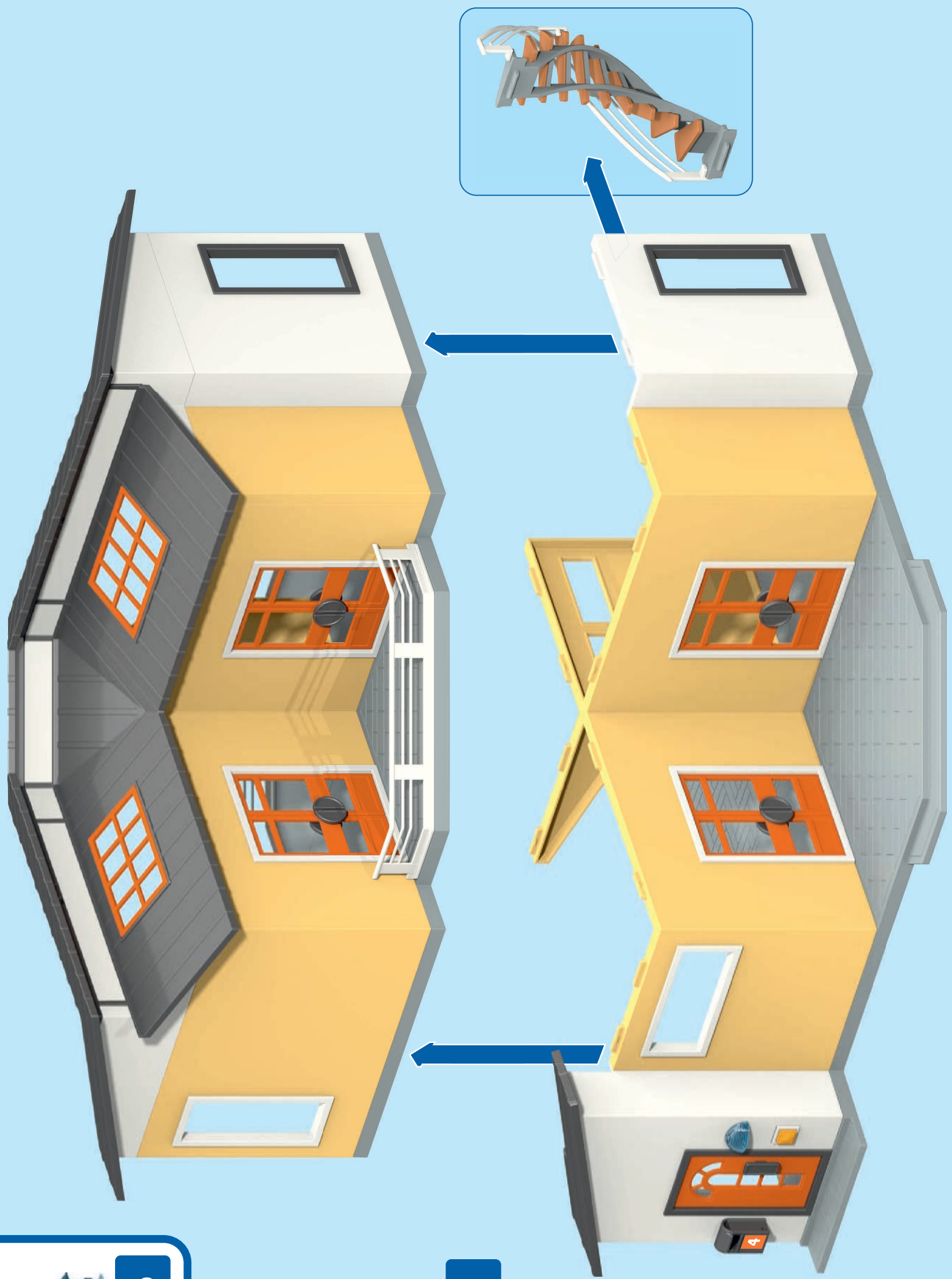

9

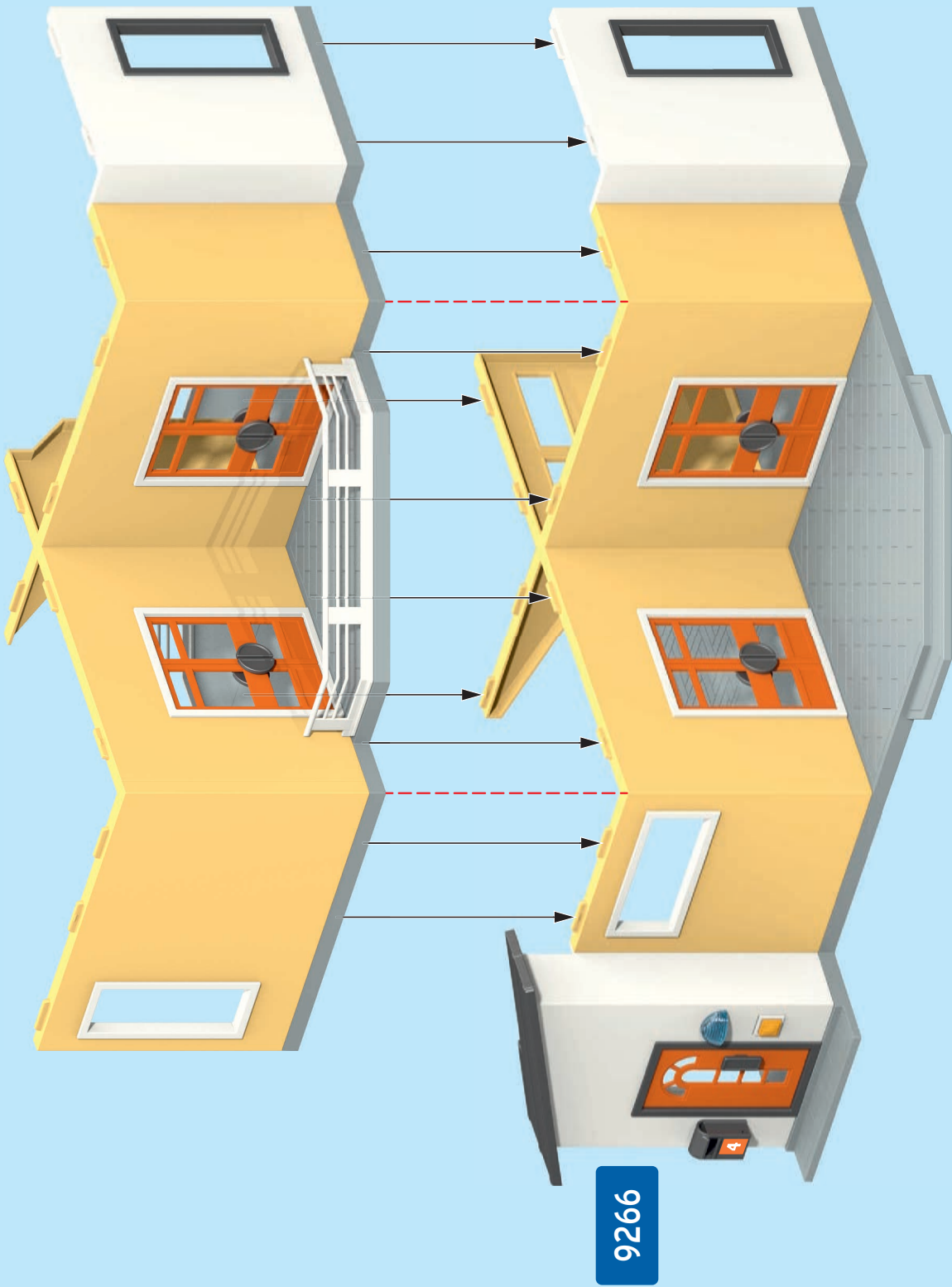

9266

10

9266

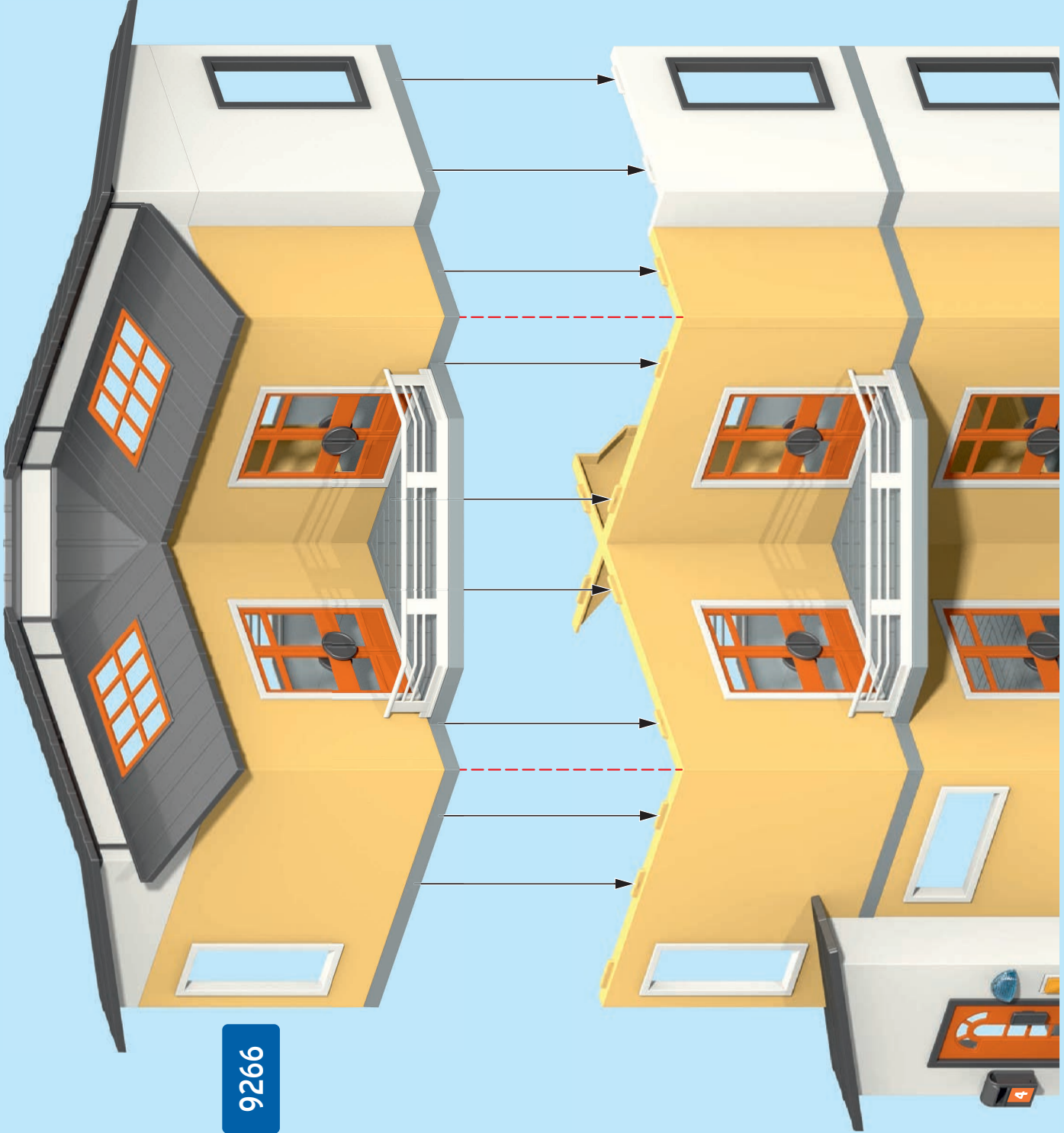

11

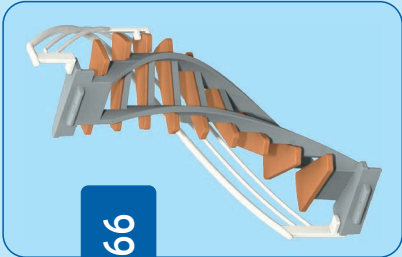
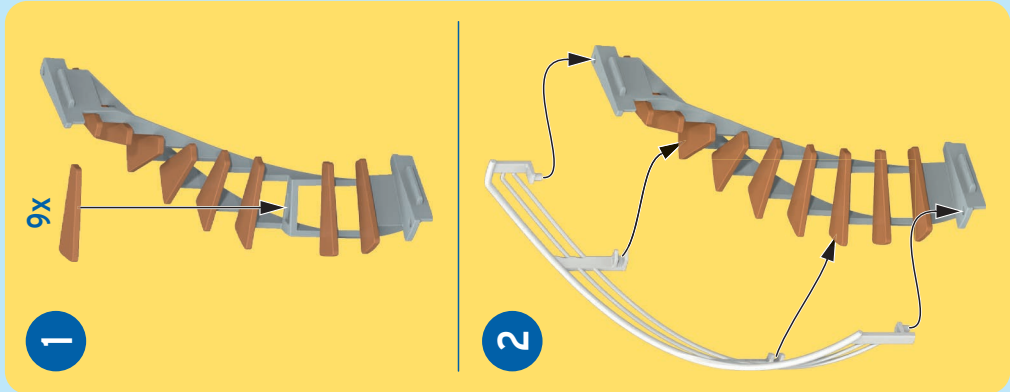

9266



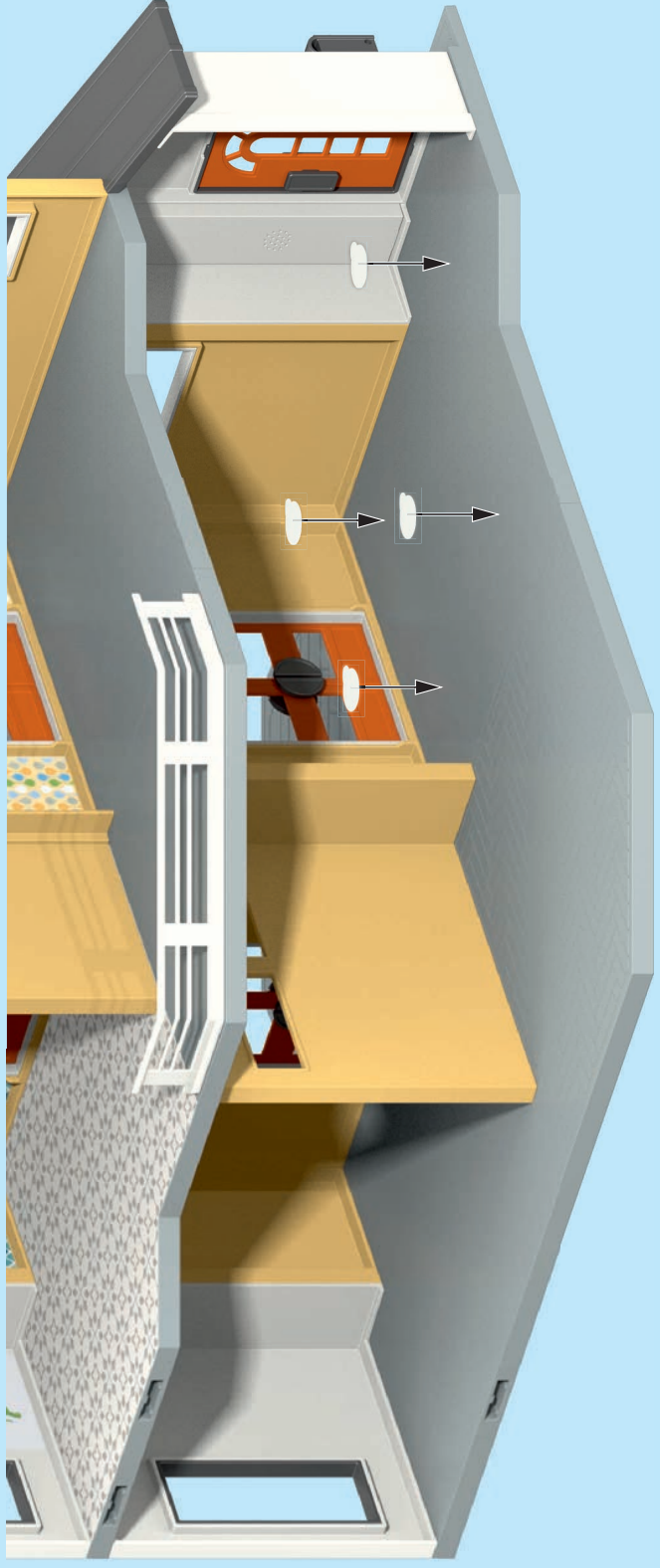

12

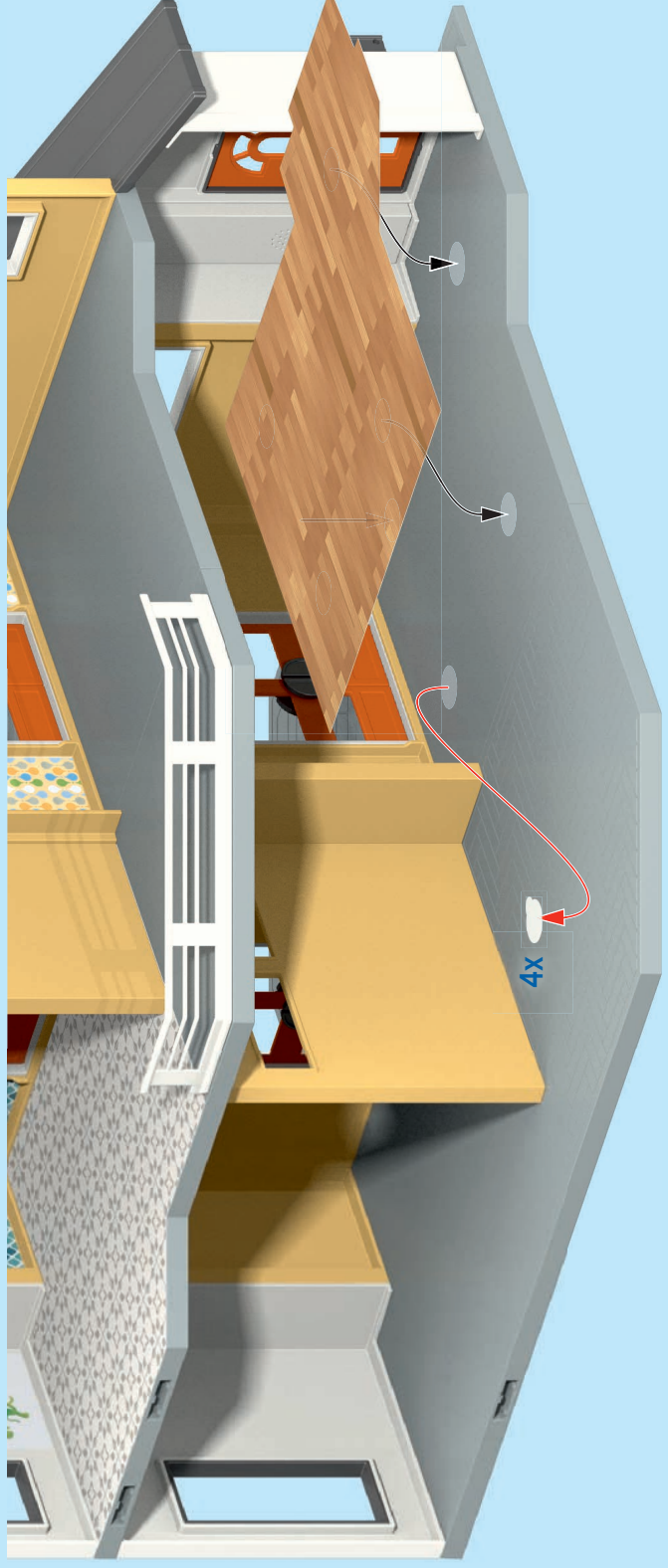
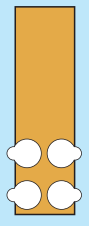

13

4X





oder  
or  
ou



30 25 2490



30 00 1535



30 61 5122

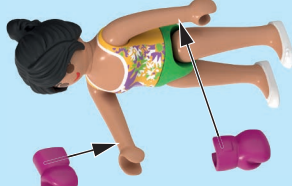

30 14 2062



30 11 4980



30 03 3142



30 25 0143



2

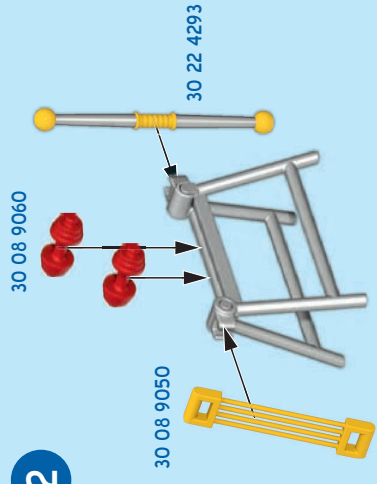

1

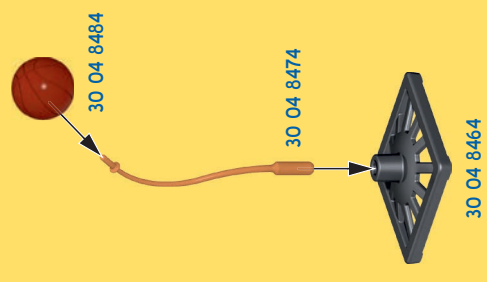
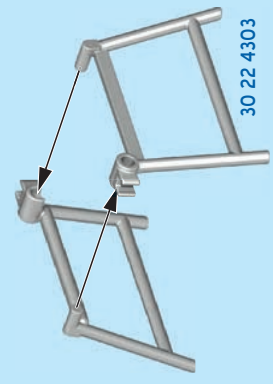

30 21 1672

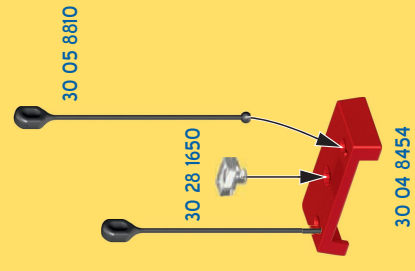

30 24 2462

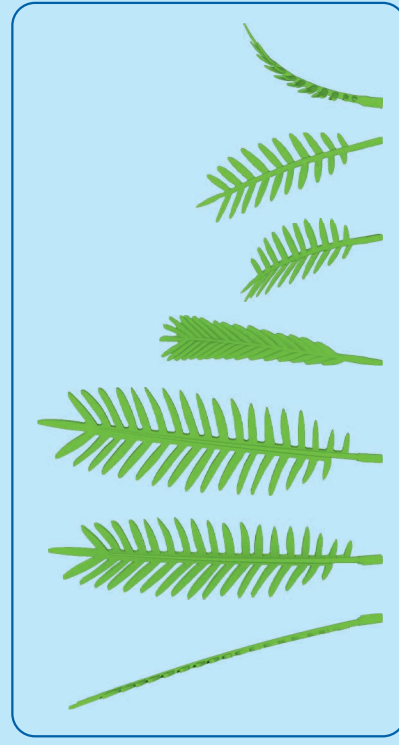
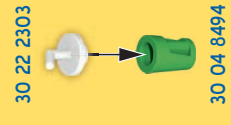

30 61 6430

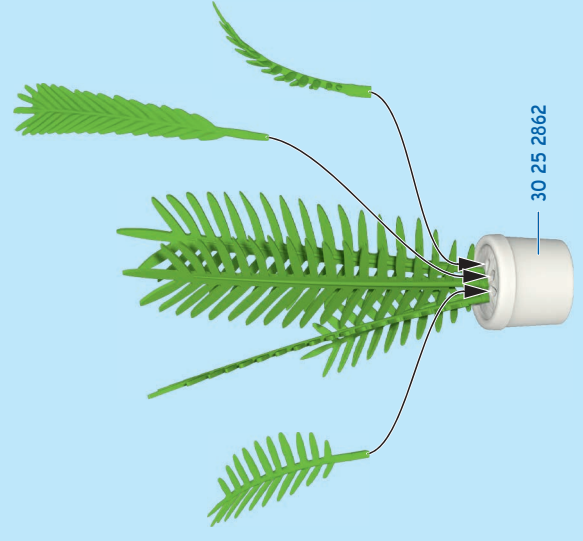

30 25 2862

1

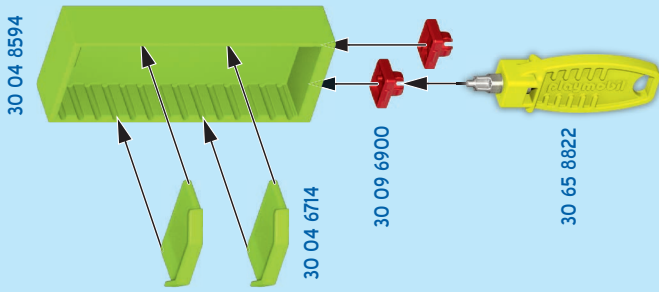

2

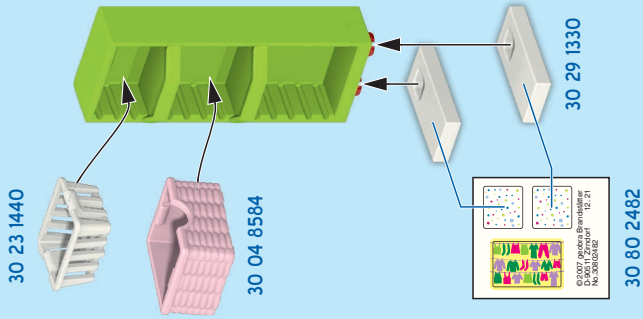

1

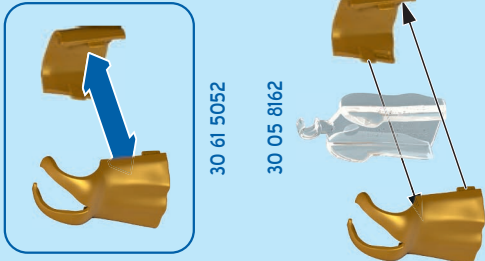

2

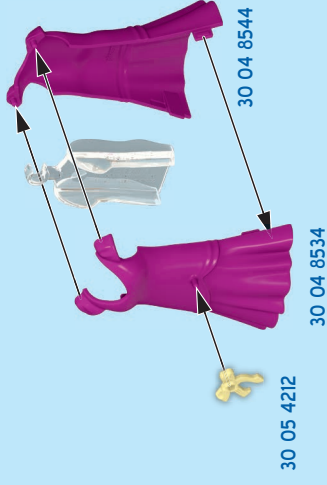

3

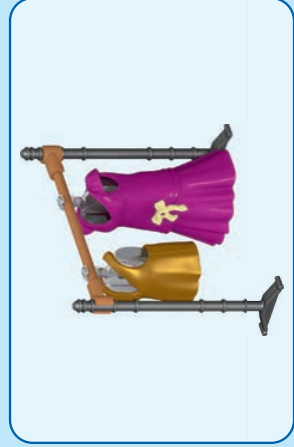

oder  
or  
ou



1

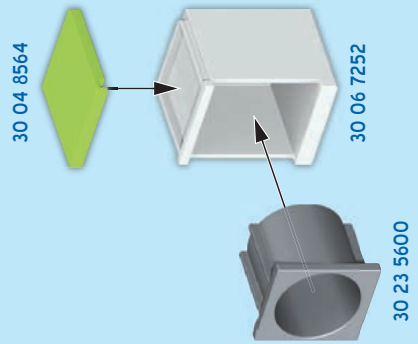

2



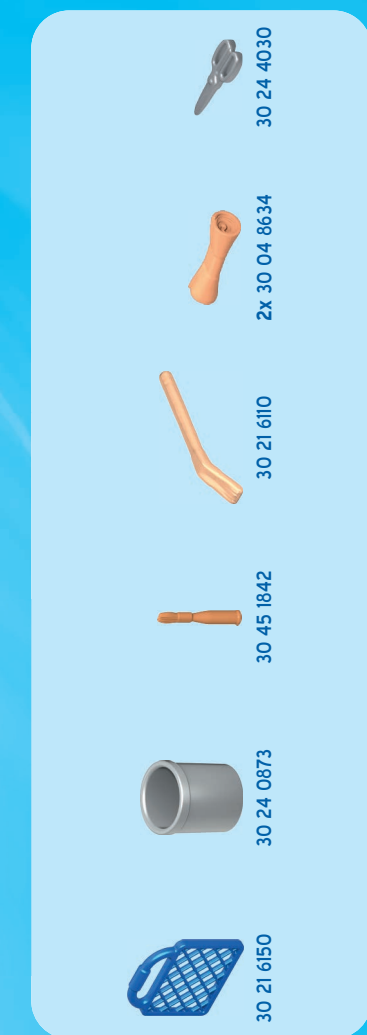
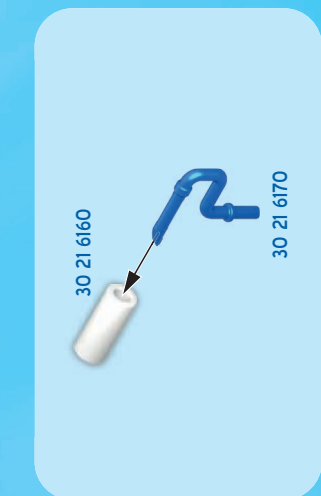
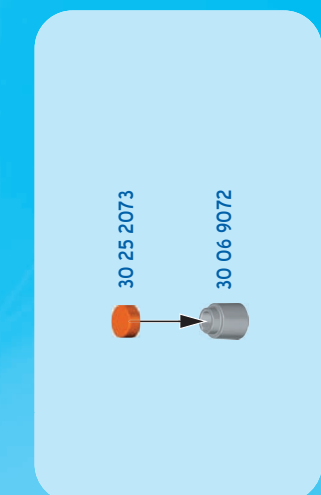
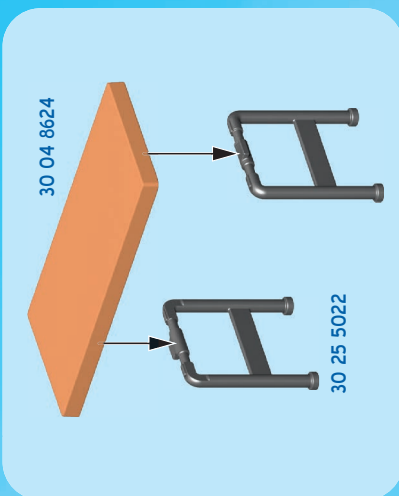
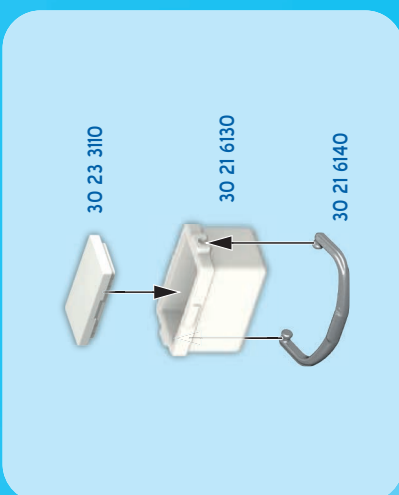
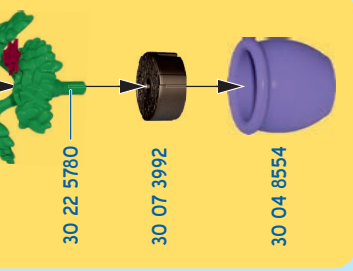
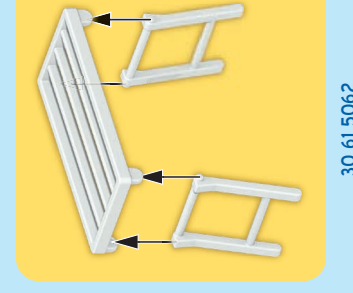
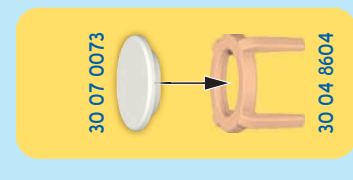
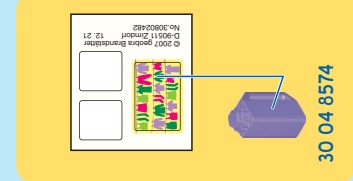
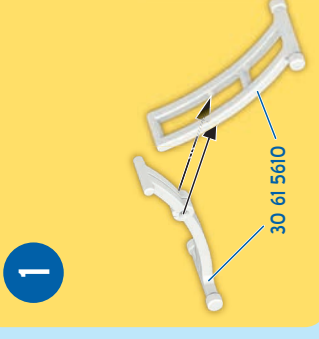
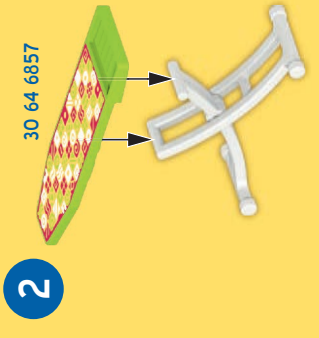



+

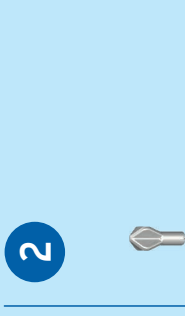
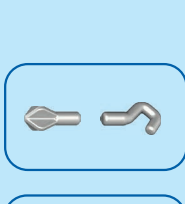
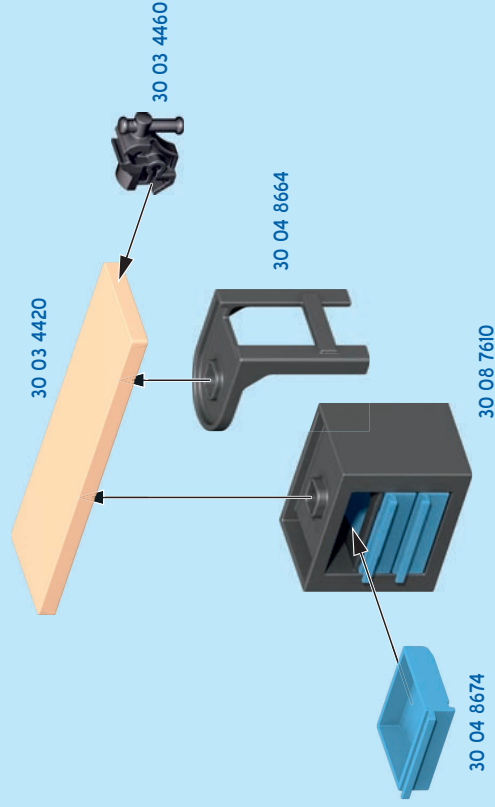

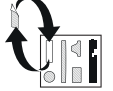
 DE AT CH LU BE repositionierbar  
 US GB CA MT IE repositionable  
 FR CA BE LU CH repositionnable  
 ES MX repositionable  
 NL BE herpositioneerbaar  
 IT CH repositionabile

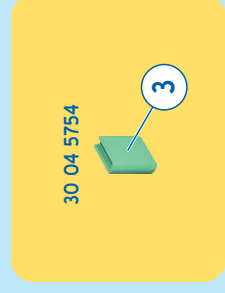
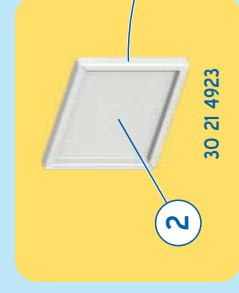
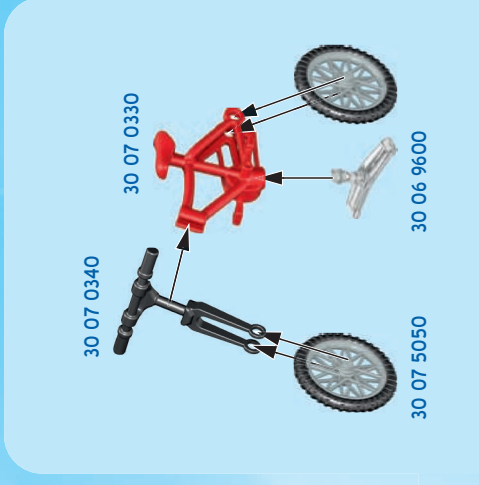
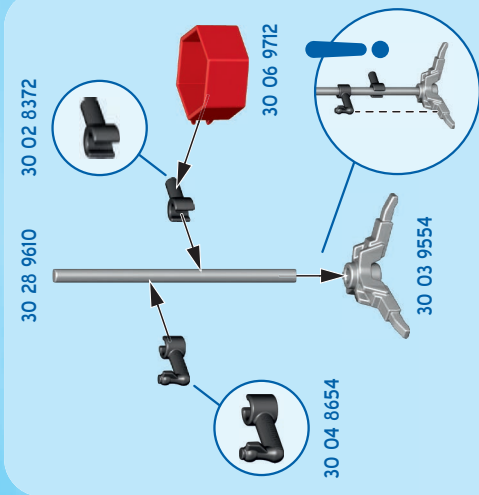

30 61 5072

30 60 9590

30 04 8734

30 05 9903





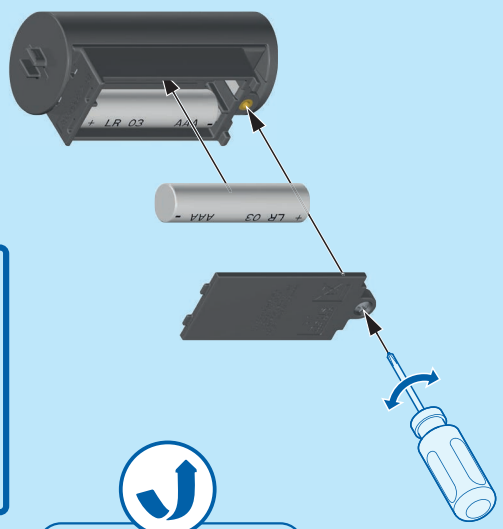
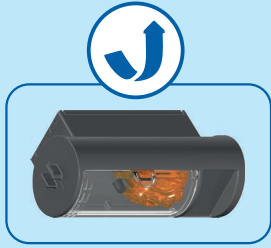



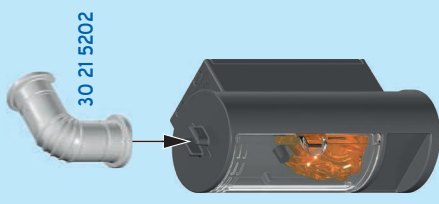

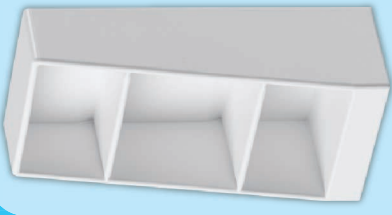







30 04 8694

**1** + 2x MICRO 1.5V R03 - LR03 - AAA -



**2**



					
30 04 8704	30 20 0322	30 20 0222	30 04 8684	30 64 6867	30 82 1232
					
30 04 8644	30 03 7832	30 09 4620	30 08 5750	30 04 8754	30 82 1242
					
30 63 4520	2x 30 29 1460	30 20 2102	30 03 4630	2x 30 27 3430	30 82 1262

**AUS / OFF**  
**ARRÊT**



**AN / ON**  
**MARCHE**

- (DE) (AT) (CH) (LU) (BE) **ACHTUNG!** Das Spielzeug erzeugt Lichtblitze, die bei empfindlichen Personen Epilepsie auslösen können.
- (US) (GB) (CA) (MT) (IE) **WARNING!** This toy produces flashes that may trigger epilepsy in sensitised individuals.
- (FR) (CA) (BE) (LU) (CH) **ATTENTION!** Ce jouet crée des flashes lumineux susceptibles de déclencher des crises d'épilepsie chez certaines personnes.
- (ES) (MX) **¡ADVERTENCIA!** El juguete genera destellos de luz que, en personas sensibles, pueden provocar epilepsia.
- (NL) (BE) **WAARSCHUWING!** het speelgoed veroorzaakt lichtflitsen, die bij gevoelige personen epilepsie kunnen veroorzaken.
- (IT) (CH) **AVVERTENZA!** Il giocattolo genera lampi di luce che possono provocare epilessia nei soggetti sensibili.
- (PT) **ATENÇÃO!** O brinquedo imite raios de luz que, em caso de pessoas sensíveis pode provocar epilepsia.
- (DK) **ADVARSEL!** Dette legetøj frembringer lysglimt, der kan fremprovokere epileptiske anfald hos særlig følsomme mennesker.
- (NO) **ADVARSEL!** Leketøyet fremkaller lynlys som kan utløse epilepsi hos ømfintlige personer.
- (SE) (FI) **VARNING!** Den här leksaken avger ljusblixtar, som kan utlösa epilepsi hos känsliga personer.
- (FI) **VAROITUS!** Lelu välikyy ja voi aiheuttaa epilepsiaohtauksen herkimille henkilöille.
- (HU) **FIGYELMEZTETÉS!** A játékszer fényfelvillanásokat okoz, amely az arra érzékeny személyeknek epilepsziás rohamokat válthat ki!
- (CZ) **UPOZORNĚNÍ!** Hračka vydává světelné záblesky, které mohou u citlivých osob vyvolat epilepsii.
- (EE) **HOIATUS!** Mänguasi tekitab valgusvälkatusi, mis võivad tundlikel inimestel vallandada epileptilisi hoogusid.
- (LV) **BRĪDINĀJUMS!** Rotāļlietai darbojoties, rodas gaismas zibšņi, kas var izraisīt epilepsijas lēkmi jutīgām personām.
- (LT) **ĮSPĖJIMAS!** Žaislas generuoja šviesos blyksnius, kurie jautriems asmenims gali sukelti epilepsiją.
- (SI) **OPOZORILO!** Igrača oddaja bliske, ki pri občutljivih osebah lahko sprožijo epileptične napade.
- (SK) **UPOZORNENIE!** Hračka vytvára záblesky svetla, ktoré môžu u citlivých osôb vyvolať epilepsiu.
- (PL) **OSTRZEŻENIE!** Zabawka wytwarza błyski, które u osób wrażliwych mogą wywoływać napady epilepsji.
- (TR) (CY) **ΔΙΚΚΑΤ!** Ουτσάκ, hassas kişilerde epilepsi nöbetine neden olabilecek ışık flaşları oluşturur. **ΠΡΟΕΙΔΟΠΟΙΗΣΗ!** Το παιχνίδι παράγει αστραπιαίο φως που μπορεί να προκαλέσει επιληψία σε ευαίσθητα άτομα.
- (RO) **AVERTISMENT!** Jucăria produce pulsuri de lumină care pot declanșa crize de epilepsie la persoanele sensibile.
- (BG) **Внимание!** Играчката произвежда светкавици, които могат да предизвикат епилепсия при чувствителни лица.
- (HR) **UPOZORENJE!** Igračka proizvodi bljeskove koji kod osjetljivih osoba mogu izazvati epilepsiju.
- (RU) **Внимание!** Игрушка генерирует вспышки света, которые могут вызвать эпилептический припадок у чувствительных людей.
- (CN) **警告!** 本玩具产生闪光, 在敏感者有导致癫痫发作的可能。

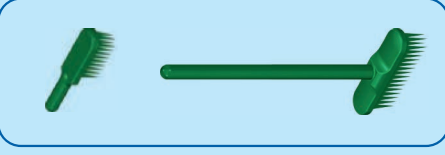

30 60 0270

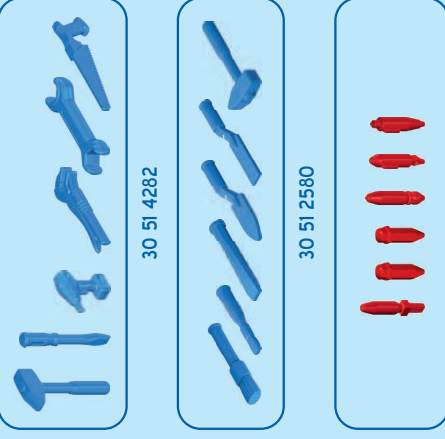

30 51 4282

30 51 2580

30 51 6340

(US)

**NOTE:** This equipment has been tested and found to comply with the limits for a Class B digital device, pursuant to part 15 of the FCC Rules. These limits are designed to provide reasonable protection against harmful interference in a residential installation. This equipment generates, uses and can radiate radio frequency energy and, if not installed and used in accordance with the instructions, may cause harmful interference to radio communications. However, there is no guarantee that interference will not occur in a particular installation. If this equipment does cause harmful interference to radio or television reception, which can be determined by turning the equipment off and on, the user is encouraged to try to correct the interference by one or more of the following measures:

- Reorient or relocate the receiving antenna.
- Increase the separation between the equipment and receiver.
- Connect the equipment into an outlet on a circuit different from that to which the receiver is connected.
- Consult the dealer or an experienced radio/TV technician for help.

**PLAYMOBIL USA, INC.**  
26 Commerce Drive  
Cranbury, NJ 08512  
Phone 1-800-752-9662 or 609-395-5566  
Email: service@playmobilusa.com

**Caution:** Changes or modifications not expressly approved by the party responsible for compliance could void the user's authority to operate the equipment.

(US)

This device complies with Part 15 of the FCC Rules. Operation is subject to the following two conditions:  
(1) This device may not cause harmful interference, and  
(2) This device must accept any interference received, including interference that may cause undesired operation.

(CA)

**CAN ICES-3 (B)/NMB-3(B)**  
Cet équipement est conforme à la Section 15 des règlements de la FCC. Son fonctionnement est soumis aux deux conditions suivantes:  
(1) Cet équipement ne peut causer d'interférence nuisible, et  
(2) Cet équipement doit pouvoir fonctionner même s'il capte de l'interférence, induisant celle pouvant provoquer un fonctionnement indésirable.





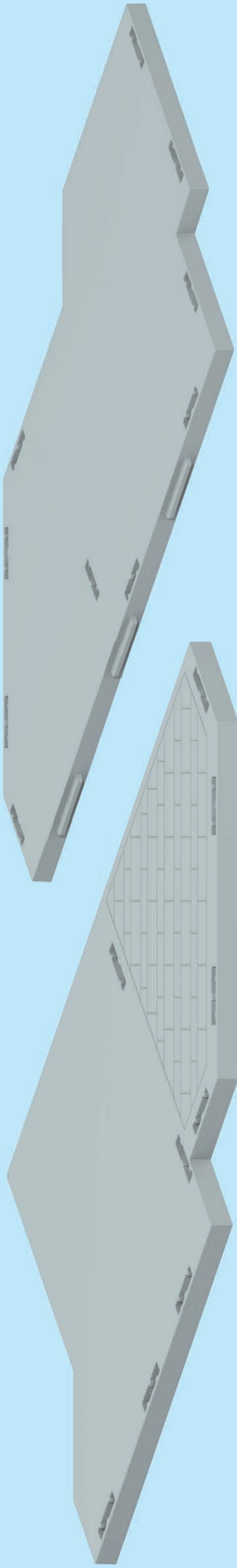

30 05 9082

30 05 9072



30 05 9002



30 05 7962

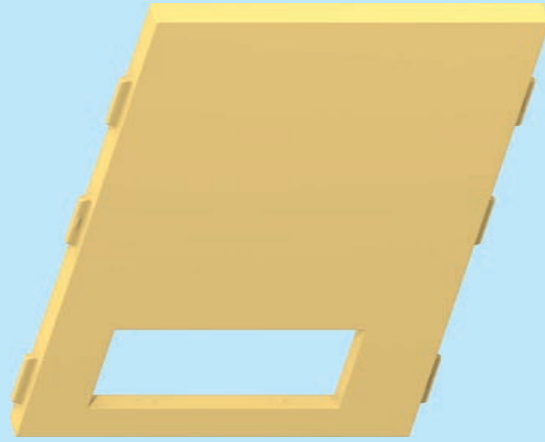

30 05 7972

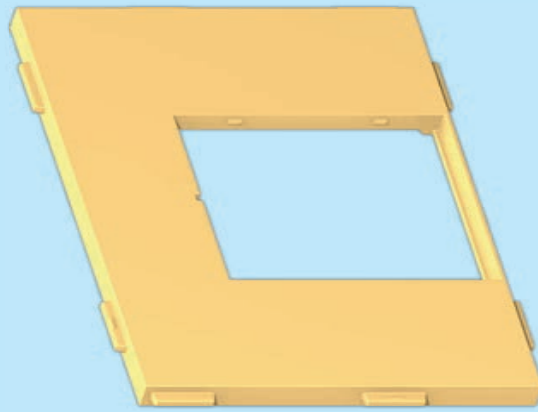

2x 30 05 7982

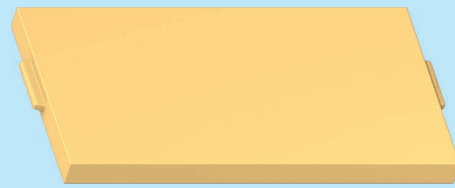

30 05 7992



2x 30 05 7872



30 05 7862

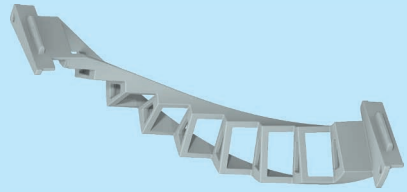

30 05 7852



30 81 6626

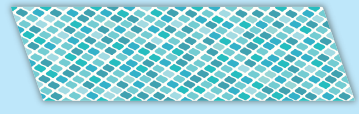

30 81 6636



30 05 9012



2x 30 05 7882



30 05 7842

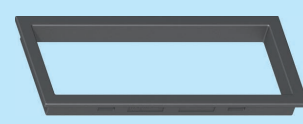

30 05 7902



4x 30 23 9513



8x 30 05 7812

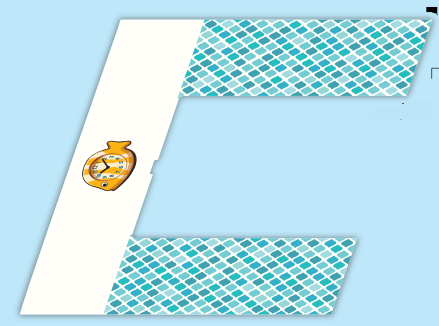

30 81 6616

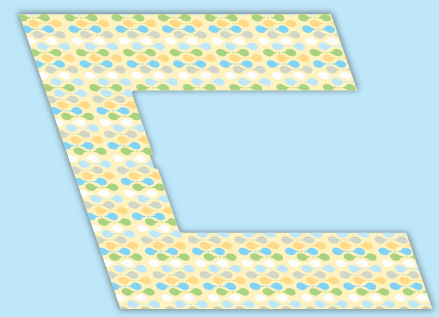

30 81 6596

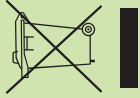

**(DK)** Vi skal alle være med til at beskytte miljøet!

- Apparatet indeholder mange materialer, der kan genvindes eller genbruges.
- Bring det til et specialiseret indsamlingssted for genbrug eller et autoriseret serviceværksted, når det ikke skal bruges mere.

**(SE)** (FI) Var rädd om miljön!

- Din apparat innehåller olika material som kan återanvändas eller återvinnas.
- Lämna den på en återvinningsstation eller på en auktoriserad serviceverkstad för omhändertagande och behandling.

**(FI)** Huolehtikaamme ympäristöstä!

- Laitteesi on varustettu monilla arvokkailla ja kierrätettävillä materiaaleilla.
- Lomitta laitteesi keräyspisteeseen tai salliseen puuttuessa vaikkapa valtuutetun huoltokäuseen, jotta laiteen osat vauriasti kierrätetään.

**(HU)** Első a környezetvédelem!

- Az Ön terméke értékes újrahasznosítható anyagokat tartalmaz.
- Kérjük készülékét ne dobja ki, hanem adjal le az erre a célra kijelölt gyűjtőhelyen.

**(CZ)** Podílejte se na ochraně životního prostředí!

- Váš přístroj obsahuje četné zhodnotitelné nebo recyklovatelné materiály.
- Svéřte jej sběrnému místu nebo, neexistuje-li, smílnivému servisnímu středisku, kde s ním bude naloženo odpovídajícím způsobem.

**(SI)** Sodelujimo pri varovanju okoljaj!

- Vaš aparat vsebuje številne dele, ki imajo svojo vrednost ali jih je še mogoče uporabiti.
- Oddajte ga na mesto za zbiranje odpadkov ali pa na pooblaščenem servisu, da bo šel v predelavo.

**(SK)** Podielajme sa na ochrane životného prostredia!

- Váš prístroj obsahuje čírne zhodnotiteľné alebo recyklovateľné materiály.
- Zverte ho sbornému miestu alebo, ak neexistuje, zmluvnému servisnému stredisku, kde s ním bude naložené zodpovedajúciím spôsobom.

**(PL)** Bierzmy czynny udział w ochronie środowiska!

- Twoje urządzenie jest zbudowane z materiałów, które mogą być poddane ponownemu przetworzeniu lub recyklingowi.
- W tym celu należy je dostarczyć do wyznaczonego punktu zbiórki.

**(GR)** (CY) Ας συμβάλουμε κι εμείς στην προστασία του περιβάλλοντος!

- Η συσκευή σας περιέχει πολλά αξιοποίησιμα ή ανακυκλώσιμα υλικά.
- Παραδώστε την παρά συσκευής σας σε κέντρο διαλογής ή σε ένα εξουσιοδοτημένο κατάστημα σέρβις.

**(RO)** Țineți cont de protecția mediului!

- Aparatul dvs. conține materii prime valoroase care pot fi revalorificate.
- Din acest motiv vă rugăm să predați aparatul dvs. la un centru de colectare din orașul sau comuna dvs.

**(BG)** Мислете за околната среда!

- Вашият уред съдържа ценни суровини, които могат да бъдат рециклирани.
- Затова върнете своя електроуред на специално място за събиране на такива отпадъци във Вашия град или община.

**(RU)** Подумайте о защите окружающей среды!

- Ваше устройство содержит ценное сырьё, которое может быть переработано.
- Поэтому, пожалуйста, верните ваше устройство в пункт сбора в вашем городе или муниципалитете.

**(CN)** 环保第一!

设备含有可回收和可再循环的有价值的材料，将其放回当地的市政垃圾收集点。



**(DE)** (AT) (CH) (LU) (BE) Denken Sie an den Schutz der Umwelt!

- Ihr Gerät enthält wertvolle Rohstoffe, die wieder verwendet werden können.
- Geben Sie Ihr Gerät deshalb bitte bei einer Sammelstelle Ihrer Stadt oder Gemeinde ab.

**(GB)** (MT) (IE) Environment protection first!

- Your appliance contains valuable materials which can be recovered or recycled.
- Leave it at a local civic waste collection point.

**(FR)** (LU) (CH) Participez à la protection de l'environnement !

- Votre appareil contient de nombreux matériaux valorisables ou recyclables.
- Conitez celui-ci dans un point de collecte pour que son traitement soit effectué.

**(ES)** ¡¡ Participe en la conservación del medio ambiente !!

- Su electrodoméstico contiene materiales recuperables y/o reciclables.
- Entreguelo al final de su vida útil, en un Centro de Recogida Específico o en uno de nuestros Servicios Oficiales Post Venta donde será tratado de forma adecuada.

**(NL)** (BE) Samen het milieu beschermen!

- Uw product bevat meerdere recycleerbare materialen
- Breng deze naar een afval-inzamelpunt.

**(BE)** Participez à la protection de l'environnement!

- Votre appareil contient de nombreux matériaux valorisables ou recyclables.
- Confiiez celui-ci dans un point de collecte ou à défaut dans un centre service agréé pour que son traitement soit effectué.

**(IT)** (CH) Partecipiamo alla protezione dell'ambiente!

- Il vostro apparecchio è composto da diversi materiali che possono essere riciclati.
- Lasciatelo in un punto di raccolta o presso un Centro Assistenza Autorizzato.

**(PT)** Protecção do ambiente em primeiro lugar!

- O seu produto contém materiais que podem ser recuperados ou reciclados.
- Entregue-o num ponto de recolha para possibilitar o seu tratamento.



30 81 6586

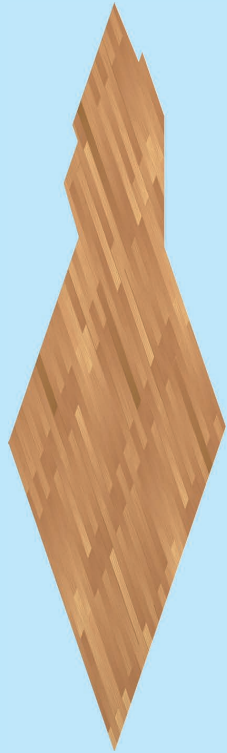

30 81 6576



2x 30 80 9313



12x 30 20 2964

**UK-Importer:**  
**Playmobil UK Ltd.**  
 Regency House  
 1 Miles Gray Road  
 Basildon  
 Essex  
 SS14 3RW  
 UK

Serviceadressen finden Sie in allen PLAYMOBIL-Prospekten  
 Addresses of Customer Service Departments are shown in all PLAYMOBIL catalogues  
 L'adresse du service consommateurs est indiquée dans tous les catalogues PLAYMOBIL  
 Troverete gli indirizzi dei centri di assistenza in tutti i cataloghi PLAYMOBIL

In alle PLAYMOBIL-catalogi, vindt u het adres van onze klantendienst.  
 Las Direcciones de los Departamentos de Servicio al Consumidor se encuentran en todos los catálogos PLAYMOBIL.  
 Η διεύθυνση του Γραφείου Εξυπηρέτησης Καταναλωτών PLAYMOBIL βρίσκεται σε όλους τους καταλόγους PLAYMOBIL.  
 pronounced: play-mö-bil



70987



9266



70986



70990



70988



70988



©2022 geobra Brandstätter Stiftung & Co. KG  
Brandstätterstr. 2-10 • 90513 Zirndorf, Germany  
05.22

